

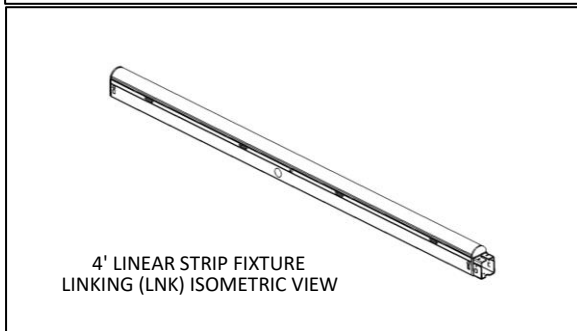

**IMPORTANT:** READ ALL INSTRUCTIONS THOROUGHLY AND CAREFULLY PRIOR TO INSTALLATION OF LINEAR SERIES FIXTURES AND RETAIN FOR FUTURE REFERENCE.

The LS1 Series of commercial and industrial LED fixtures is designed to be used in utility strip applications using suspension or surface mount installation. The LS1 Series is designed for use in 120 – 277V, 50/60Hz protected (max 20A) circuits. Size line voltage Service wire as required per the National Electric Code (NEC).

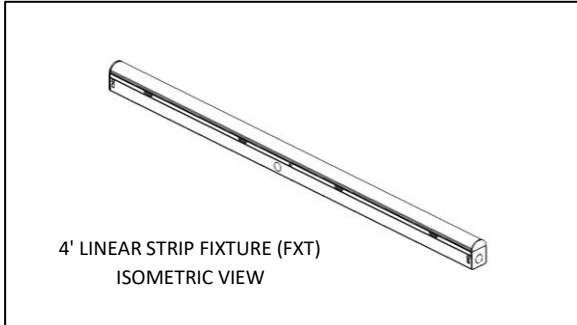

*These instructions apply to the following part numbers:*

LS10S-A1-03K-04-35/40/50-80-FR-FXT or LNK-[xxx]-10V  
LS10S-A1-04K-04-35/40/50-80-FR-FXT or LNK-[xxx]-10V  
LS10S-A1-05K-04-35/40/50-80-FR-FXT or LNK-[xxx]-10V

## GENERAL NOTES:

1. FIXTURES ARE ALL 4' SECTIONS. EACH FIXTURE HAS 1 DRIVER.
2. MAKE SURE ALL WIRES AND CONNECTORS ARE UL-LISTED. IF THE ELECTRICAL SYSTEM CONTAINS NO GROUND WIRE, CONSULT WITH A QUALIFIED ELECTRICIAN BEFORE PROCEEDING WITH THE INSTALLATION.
3. SUSPENSION CABLE, CHAIN OR CEILING JUNCTION BOX PROVIDED BY CONTRACTOR SHALL BE RATED TO SUPPORT WEIGHT OF FIXTURE(S) – INCLUDING ALL ACCESSORIES AND OPTIONS. AIRCRAFT SUSPENSION CABLE MAY BE ORDERED SEPARATELY FROM FLEX LIGHTING SOLUTIONS OR OTHERWISE PROVIDED BY CONTRACTOR.

## ITEMS NOT INCLUDED:

**(BUT REQUIRED FOR INSTALLATION):**

### PERSONAL PROTECTIVE EQUIPMENT

- SCREWDRIVER
- PLIERS
- SUPPLY CONDUCTORS (BUILDING LINE POWER)
- RECEPTACLE (IF APPLICABLE)

## ITEMS INCLUDED:

- LINEAR STRIP LED LIGHT FIXTURE (FXT OR LNK)
- CORD AND PLUG (OPTIONAL; SOLD SEPARATELY)
- MAY ALSO INCLUDE SOME OPTIONAL ACCESSORIES (IF ORDERED)

REFER TO SPECIFICATION SHEET FOR ALL POSSIBLE OPTIONS.





**IMPORTANT: READ ALL INSTRUCTIONS THOROUGHLY AND CAREFULLY PRIOR TO INSTALLATION OF LINEAR SERIES FIXTURES AND RETAIN FOR FUTURE REFERENCE.**

## **WARNING:**

### **FAILURE TO FOLLOW THESE INSTRUCTIONS MAY RESULT IN DEATH, SERIOUS INJURY OR SIGNIFICANT PROPERTY DAMAGE.**

THIS PRODUCT MUST BE INSTALLED IN ACCORDANCE WITH APPLICABLE BUILDING AND ELECTRICAL CODES, BY A QUALIFIED PERSON WHO IS FAMILIAR WITH THE CONSTRUCTION AND OPERATION OF THE PRODUCT AND THE HAZARDS INVOLVED.

CE PRODUIT DOIT ÊTRE INSTALLÉ SELON LE CODE D'INSTALLATION PERTINENT, PAR UNE PERSONNE QUI CONNAÎT BIEN LE PRODUIT ET SON FONCTIONNEMENT AINSI QUE LES RISQUES INHÉRENTS

- FULLY INSPECT LENS AND HOUSING OF THE FIXTURE PRIOR TO INSTALLATION. IF DAMAGED, NOTIFY FACTORY.
- TO AVOID ELECTRIC SHOCK: DISCONNECT ELECTRICAL POWER (LINE POWER) BEFORE AND DURING INSTALLATION AND MAINTENANCE.
- VERIFY SUPPLY VOLTAGE IS SAME AS RATED FIXTURE VOLTAGE. THE ELECTRICAL RATINGS OF THE FIXTURE ARE CLEARLY INDICATED ON THE PRODUCT LABEL.
- BE CAUTIOUS OF ANY SHARP EDGES. WEAR PROPER SAFETY GEAR (SUCH AS GLOVES AND SAFETY GLASSES) WHILE HANDLING.

### **CAUTION - RISK OF PERSONAL INJURY**

ACCOUNT FOR SMALL PARTS AND DESTROY PACKING MATERIAL, AS THESE MAY BE HAZARDOUS TO CHILDREN

### **CAUTION - RISK OF FIRE**

- MINIMUM 90° C SUPPLY CONDUCTORS.
- NOT INTENDED FOR RECESSED INSTALLATION IN CEILINGS OR SOFFITS.

### **WARNING -**

- RISK OF FIRE OR ELECTRIC SHOCK—LUMINAIRE WIRING AND ELECTRICAL PARTS MAY BE DAMAGED WHEN DRILLING FOR INSTALLATION OF RETROFIT ASSEMBLY HARDWARE. CHECK FOR ENCLOSED WIRING AND COMPONENTS.  
AVERTISSEMENT - RISQUE D'INCENDIE OU DE CHOC ÉLECTRIQUE. CÂBLAGE DU LUMINAIRE ET PIÈCES ÉLECTRIQUES PEUVENT ÊTRE ENDOMMAGÉS LORS DU FORAGE POUR L'INSTALLATION DU KIT DE CONVERSION À DEL. VÉRIFIER LE CÂBLAGE ET LES COMPOSANTS CLOS
- IF AC INPUT WIRING PASSES THROUGH FIXTURE HOUSINGS IN CONTINUOUS RUN INSTALLATIONS, MAX AMBIENT ON ALL FIXTURES CONTAINING A FACTORY INSTALLED BATTERY BACK UP SYSTEM IS 40°C.

### **CAUTION - RISK OF ELECTRIC SHOCK**

- SUITABLE FOR DAMP LOCATIONS.  
CONVIENT AUX EMPLACEMENTS HUMIDES.
- SUITABLE FOR OPERATION IN AMBIENT NOT EXCEEDING 45 °C.  
PEUT ÊTRE UTILISÉ À UNE TEMPÉRATURE AMBIANTE N'EXCÉDANT PAS 45°C.
- MODELS USING THROUGH WIRE (LNK) AND/OR EMERGENCY BACK-UP - SUITABLE FOR OPERATION IN AMBIENT NOT EXCEEDING 40 °C.  
MODÈLES UTILISANT UN FIL DE SUSPENSION (LNK) ET / OU DE SAUVEGARDE D'URGENCE - PEUT ÊTRE UTILISÉ À UNE TEMPÉRATURE AMBIANTE N'EXCÉDANT PAS 40°C.
- USE INDOORS ONLY.
- TURN POWER OFF BEFORE SERVICING -- SEE INSTRUCTIONS.
- PROPERLY GROUND FIXTURE.

### **WARNING -**

- ENSURE NO BARE WIRES ARE EXPOSED OUTSIDE THE ELECTRICAL CONNECTIONS.
  - TO PREVENT WIRING DAMAGE OR ABRASION, DO NOT EXPOSE WIRING TO EDGES OR OTHER SHARP OBJECTS.
  - ONLY THOSE OPEN HOLES INDICATED IN THE PHOTOGRAPHS AND/OR DRAWINGS MAY BE MADE OR ALTERED AS A RESULT OF KIT INSTALLATION. DO NOT LEAVE ANY OTHER OPEN HOLES IN AN ENCLOSURE OF WIRING OR ELECTRICAL COMPONENTS.
- SEULS LES OUVERTURES INDIQUÉES DANS LES PHOTOS ET/OU LES DESSINS PEUVENT ÊTRE FAITS OU MODIFIÉS À LA SUITE DE L'INSTALLATION DU NÉCESSAIRE. IL EST INTERDIT DE LAISSER D'AUTRES OUVERTURES DANS UN BOÎTIER DE CÂBLAGE OU DE COMPOSANTS ÉLECTRIQUES.

THESE INSTRUCTIONS DO NOT ATTEMPT TO COVER ALL INSTALLATION AND MAINTENANCE SITUATIONS. FOR MORE INFORMATION OR QUESTIONS REGARDING THE INSTALLATION OR USE OF THE ESSENTIALS FIXTURE, CALL 913-851-3000 OR EMAIL AT [LIGHTING.TECH@FLEX.COM](mailto:LIGHTING.TECH@FLEX.COM).

## **MAINTENANCE**

LINEAR STRP FIXTURES SHOULD BE DRY DUSTED PERIODICALLY. THE FROSTED LENS CAN BE CLEANED WITH DAMP OR DRY CLOTH. NO SPECIAL CLEANER REQUIRED.

## **TROUBLESHOOTING**

TURN ELECTRICITY OFF AT THE MAIN CIRCUIT BREAKER, PANELBOARD, FUSE BOX OR DISCONNECT. DO NOT ATTEMPT TO TROUBLESHOOT WITH THE POWER ON.

ISSUE 1 - LIGHT DOES NOT COME ON

1. VERIFY THAT POWER IS BEING DELIVERED TO THE FIXTURE. CHECK ALL UPSTREAM CIRCUIT BREAKERS, FUSES AND DISCONNECTS TO ENSURE THEY ARE ON AND IN PROPER WORKING ORDER.
2. CONFIRM ALL ELECTRICAL CONNECTIONS ARE COMPLETE AND CONTINUOUS.
3. IF THE ISSUE REMAINS UNRESOLVED, CONTACT FLEX LIGHTING SOLUTIONS.

ISSUE 2 - ONE OR MORE LEDS ARE OUT WHILE OTHERS REMAIN ON

1. DETERMINE IF REPLACEMENT IS DESIRED. AFTER ONE OR MORE LEDS FAILS, THE FIXTURE MAY CONTINUE TO OPERATE NORMALLY, ALTHOUGH WITH A REDUCED LUMEN OUTPUT.
2. IF REPLACEMENT FIXTURE IS DESIRED, CONTACT FLEX LIGHTING SOLUTIONS.

## **WARRANTY SUPPORT**

PHONE: +1 913-851-3000

EMAIL: [LIGHTING.TECH@FLEX.COM](mailto:LIGHTING.TECH@FLEX.COM)





**IMPORTANT:** READ ALL INSTRUCTIONS THOROUGHLY AND CAREFULLY PRIOR TO INSTALLATION OF LINEAR SERIES FIXTURES AND RETAIN FOR FUTURE REFERENCE.

## GENERAL INSTRUCTIONS:

### PREPARING TO INSTALL

1. CONSULT A LOCAL LICENSED ELECTRICIAN OR ELECTRICAL CONTRACTOR PRIOR TO INSTALLATION.
2. REVIEW WARNINGS FOUND IN THIS DOCUMENT PRIOR TO STARTING WORK.
3. INSPECT PACKAGE(S) FOR SIGNS OF DAMAGE. NOTIFY CARRIER IMMEDIATELY IF FIXTURE PACKAGING IS DAMAGED.
4. UNPACK THE FIXTURES FROM PACKAGING. RECYCLE AND PROPERLY DISPOSE OF PACKAGING.
5. INSPECT FIXTURES. IF THERE IS ANY FIXTURE DAMAGE OBSERVED, TAKE PHOTOGRAPHS AND IMMEDIATELY CONTACT [LIGHTING.TECH@FLEX.COM](mailto:LIGHTING.TECH@FLEX.COM).
6. TURN OFF ELECTRICITY AT THE MAIN CIRCUIT BREAKER, PANELBOARD, FUSE BOX OR DISCONNECT.

### DO NOT ATTEMPT TO INSTALL FIXTURE WITH THE POWER ON.

7. ENSURE FIXTURE IS PROPERLY RATED FOR RESPECTIVE LOCATION.
8. MAKE SURE THE MOUNTING SURFACE IS CAPABLE OF SUPPORTING WEIGHT OF FIXTURE.
9. MAX AMBIENT REDUCED 5°C WHEN MOUNTED NEAR CEILING.
10. ENSURE PROPER AIRFLOW AROUND FIXTURE.

### REMOVING LED LIGHT COVER (FXT AND LNK):

1. FOR FXT FIXTURES, REMOVE THE SAFETY SCREW NEAR THE CENTER OF THE LED CHASSIS. KEEP FOR LATER USE.
2. GENTLY SQUEEZE THE LINEAR HOUSING BELOW THE SIDE TABS AND REMOVE THE LED LIGHT COVER TO ACCESS FIXTURE WIRING. START FROM ONE END AND CONTINUE DOWN THE FIXTURE.
3. DISCONNECT DRIVER CONNECTOR FROM LED LIGHT COVER.
4. SET LED LIGHT COVER ASIDE UNTIL READY TO MAKE ELECTRICAL CONNECTIONS. REFER TO "MAKING ELECTRICAL CONNECTIONS" FOR WIRING INFORMATION.
5. DETERMINE HOW FIXTURE WILL BE MOUNTED, AND GO TO APPROPRIATE INSTRUCTION.

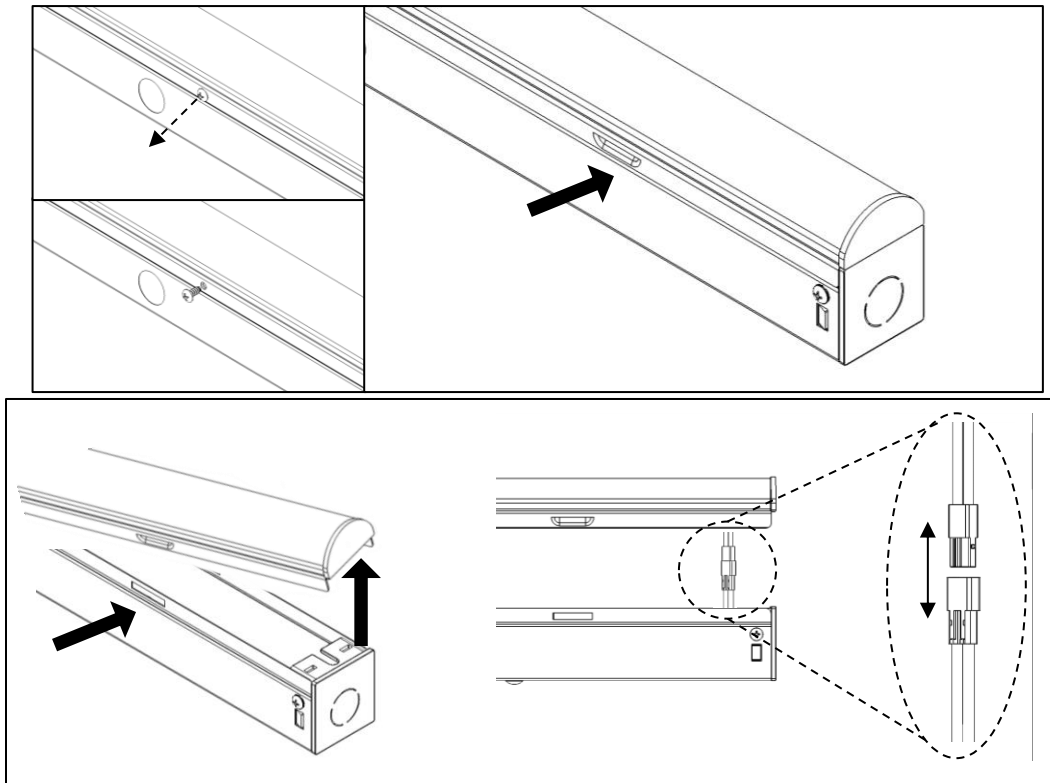



**IMPORTANT:** READ ALL INSTRUCTIONS THOROUGHLY AND CAREFULLY PRIOR TO INSTALLATION OF LINEAR SERIES FIXTURES AND RETAIN FOR FUTURE REFERENCE.

## JOINING FIXTURE SECTIONS (FXT AND LNK):

1. ALL SECTIONS ARE 4'.
2. EACH 4' SECTION HAS ITS OWN DRIVER.
3. LNK (LINKING) FIXTURES ARE PURCHASED TO BE JOINED IN A CONTINUOUS RUN. MAX 15 LINKED FIXTURES PER POWER DROP.
4. FXT (NON-LINKING FIXTURES) MAY BE LINKED WITH THE ADDITIONAL ACCESSORY "LS-MJP" (MECHANICAL JOINING PIECE), SOLD SEPARATELY. IF THIS OPTION IS CHOSEN, INSTALLER MAY WIRE PER APPLICABLE LOCAL CODE.
5. MOUNTING MAY BE DONE ONE FIXTURE AT A TIME, AND THEN JOINED TOGETHER.
6. DO NOT SUPPORT CONTINUOUS ROW OF FIXTURES FROM JUST ONE END. SUPPORT THE ENTIRE RUN WHILE HANDLING OR MOUNTING.
7. ORIENT EACH FIXTURE SECTION IN THE SAME DIRECTION. PLACE FIXTURES END TO END AS THEY WOULD BE INSTALLED.
8. REMOVE LIGHT COVER FROM EACH SECTION. (SEE "REMOVING LIGHT COVER INSTRUCTION")
9. LNK FIXTURES COME WITH ONE END OF THE FIXTURE WITH A PLASTIC JOINING PIECE (MALE TO MALE CONNECTOR) ON ONE SIDE OF THE FIXTURE. THE OTHER SIDE HAS A PLASTIC ENDCAP.

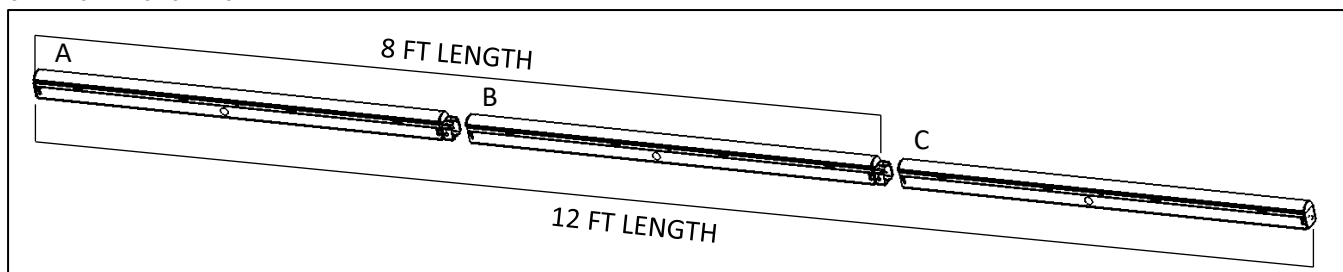

## JOINING FIXTURE SECTIONS – cont. (FXT AND LNK):

10. LOCATE THE END FIXTURE. THIS WILL BE THE START OF THE RUN.
11. REMOVE THE PLASTIC ENDCAP FROM THE SECOND FIXTURE IN THE SERIES. REMOVE THE SCREWS AND DEPRESS THE TABS HOLDING IN THE END CAP.
12. SLIDE THE SECOND FIXTURE ONTO THE LS-MJP (MECHANICAL JOINING PIECE) OF THE FIRST FIXTURE AND SNAP INTO PLACE. IT WILL SELF ALIGN. AFTER JOINING, FIXTURES HOUSINGS FROM BOTH SECTIONS SHOULD BE FLUSH TOGETHER. USE SCREWS PROVIDED TO SECURE MECHANICAL JOINING PIECE (MJP), 1 ON THE BOTTOM AND 1 ON EACH SIDE.
13. CONTINUE UNTIL DESIRED INSTALLATION IS COMPLETE. MAX 15 LINKED FIXTURES PER POWER DROP. LS-BRACE (SOLD SEPARATELY) PROVIDES ADDITIONAL SUPPORT FOR SECTIONS WHEN ONLY TWO CABLE MOUNTS ARE AVAILABLE.

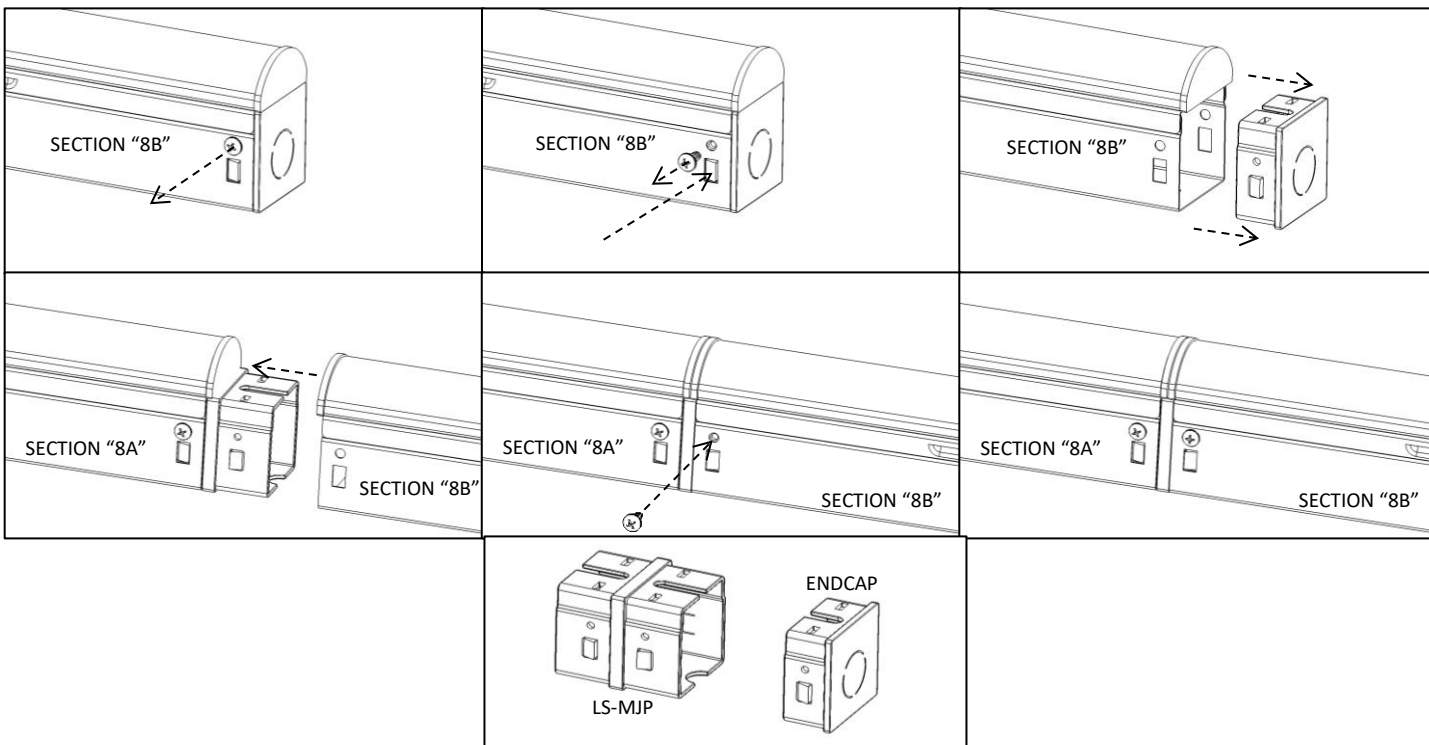



**IMPORTANT:** READ ALL INSTRUCTIONS THOROUGHLY AND CAREFULLY PRIOR TO INSTALLATION OF LINEAR SERIES FIXTURES AND RETAIN FOR FUTURE REFERENCE.

## **JOINING FIXTURE SECTIONS (FXT OCCUPANCY SENSORS AND CONTROLS):**

14. ALL FXT ACCESSORY SENSORS/CONTROLS HAVE ONE END WITH A MECHANICAL JOINING PIECE (LS-MJP) ATTACHED.
15. REMOVE LED LIGHT COVER FROM EACH SECTION. (SEE "REMOVING LIGHT COVER INSTRUCTION").
16. REMOVE THE PLASTIC ENDCAP FROM THE FIXTURE. REMOVE THE SCREWS AND DEPRESS THE TABS HOLDING IN THE END CAP.
17. SLIDE THE ACCESSORY SENSOR/CONTROL ONTO THE FIXTURE AND SNAP INTO PLACE. IT WILL SELF ALIGN.  
AFTER JOINING, FIXTURES HOUSINGS FROM BOTH SECTIONS SHOULD BE FLUSH TOGETHER. REPLACE SCREWS FROM END CAP INTO MECHANICAL JOINING PIECE (MJP) CONNECTED TO SENSOR, 1 ON EACH SIDE.
18. MAKE FINAL MOUNTING AND WIRING CONNECTIONS.

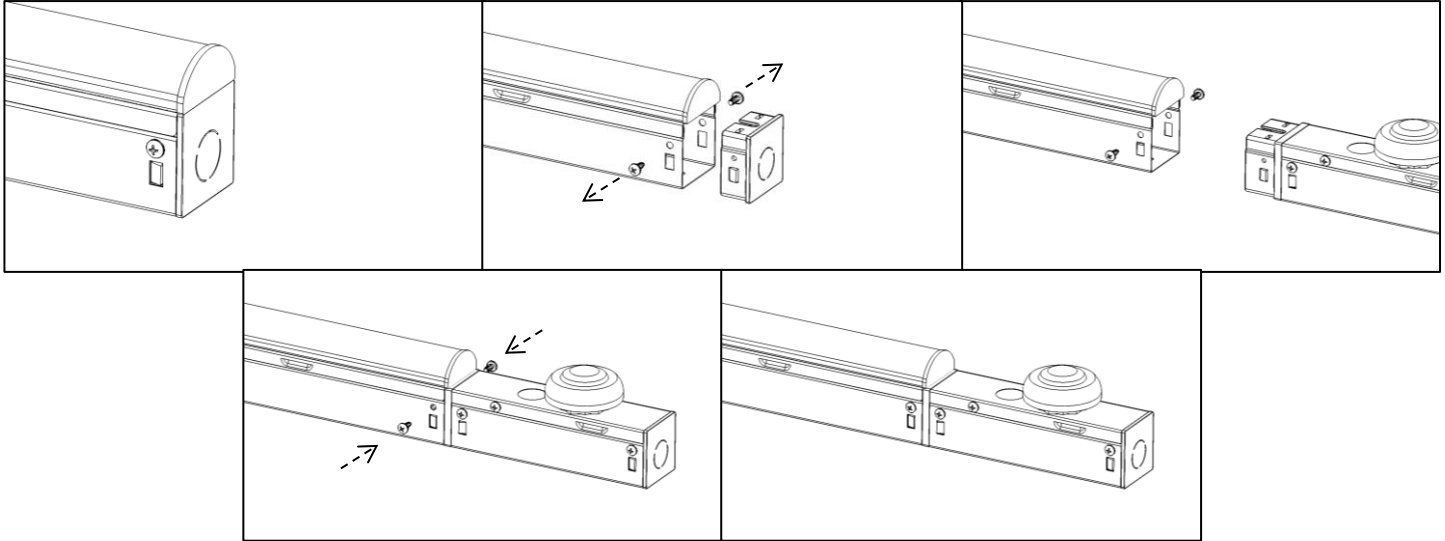

## **JOINING FIXTURE SECTIONS (LNK OCCUPANCY SENSORS AND CONTROLS):**

19. ALL LNK ACCESSORY SENSORS/CONTROLS HAVE A MECHANICAL JOINING PIECE (LS-MJP) ATTACHED AT EACH END.
20. REMOVE LED LIGHT COVER FROM EACH SECTION. (SEE "REMOVING LIGHT COVER INSTRUCTION").
21. REMOVE THE PLASTIC ENDCAP FROM THE FIXTURE (REMOVE THE SCREWS AND DEPRESS THE TABS HOLDING IN THE END CAP, IF APPLICABLE).
22. SLIDE THE ACCESSORY SENSOR/CONTROL ONTO THE FIXTURE AND SNAP INTO PLACE. IT WILL SELF ALIGN.  
AFTER JOINING, FIXTURES HOUSINGS FROM BOTH SECTIONS SHOULD BE FLUSH TOGETHER.
24. INSTALL SCREWS INTO MECHANICAL JOINING PIECE (MJP) CONNECTED TO SENSOR, 1 ON THE BOTTOM AND 1 ON EACH SIDE.
25. IF THE LNK ACCESSORY SENSOR/CONTROL IS AT THE END OF A RUN OF FIXTURES, REMOVE THE LS-MJP (MECHANICAL JOINING PIECE) FROM THE END OF THE ACCESSORY AND ATTACH A PLASTIC ENDCAP FROM ONE OF THE EXISTING LNK FIXTURES TO SEAL THE RUN. USE SCREWS PROVIDED TO SECURE END CAP, 1 ON EACH SIDE.
26. MAKE FINAL MOUNTING AND WIRING CONNECTIONS.

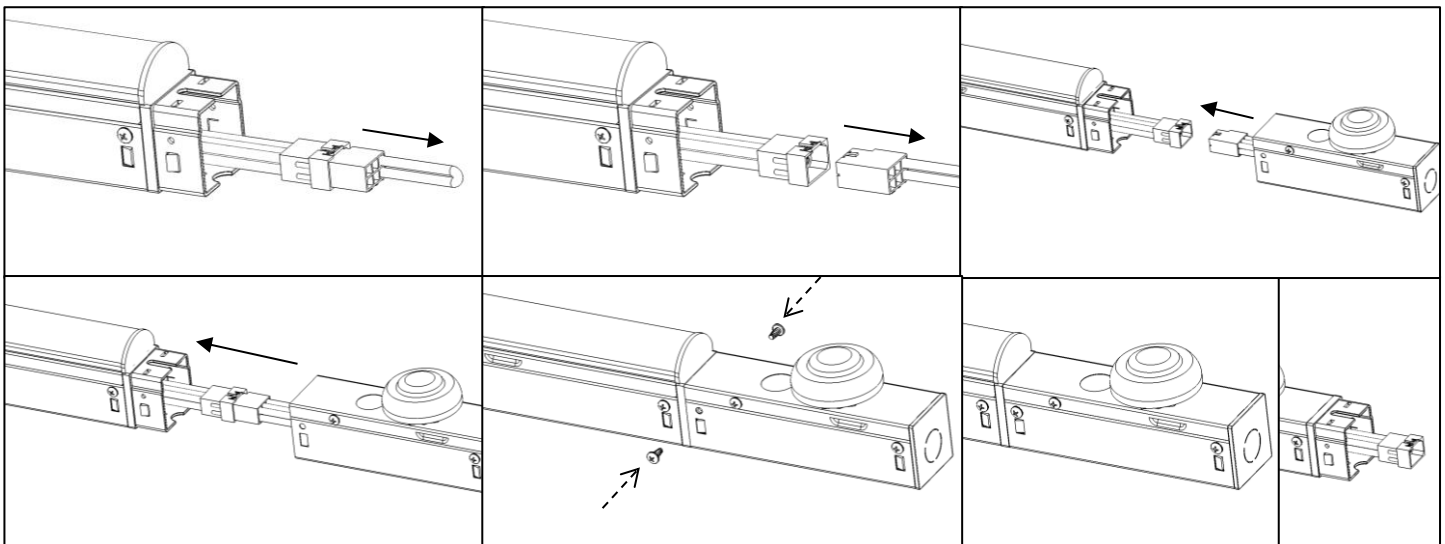



**IMPORTANT:** READ ALL INSTRUCTIONS THOROUGHLY AND CAREFULLY PRIOR TO INSTALLATION OF LINEAR SERIES FIXTURES AND RETAIN FOR FUTURE REFERENCE.

## FIXTURE (FXT or LNK) – SUSPENSION MOUNT

1. INSTRUCTION TO FOLLOW USES FLS HANGERKIT (SOLD SEPARATELY).

### LS-CABLEKIT– ITEMS INCLUDED:

- SINGLE TOGGLE AND GRIPPER, 2 EACH.

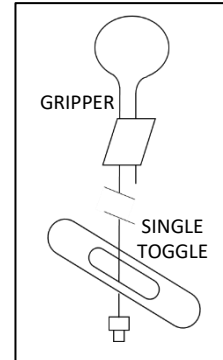

## INSTALLING SUSPENSION MOUNT (FXT and LNK):

1. SEE GENERAL INSTRUCTIONS AT THE FRONT OF THIS INSTRUCTION.
2. 4' SECTION: PRESS GRIPPER AGAINST CABLE SO GRIPPER AND CABLE ARE PARALLEL.
3. INSERT SINGLE GRIPPER/CABLE INTO FIXTURE THROUGH KEYHOLE AT END OF FIXTURE.
4. PUSH GRIPPER/CABLE THROUGH HOLE UNTIL GRIPPER CANNOT BE HANDLED (IS NOT SEEN).

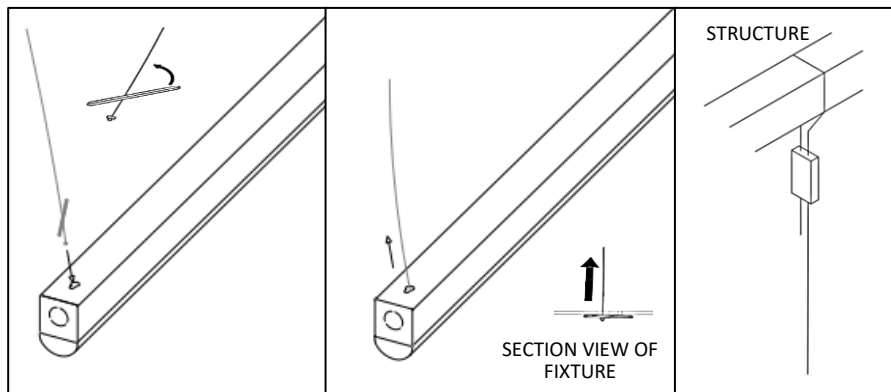

5. PULL CABLE TIGHT. GRIPPER LAYS INSIDE FIXTURE HOUSING AND WILL NOT PULL OUT.
6. SECURE HANGER CABLE TO STRUCTURE.
  - 4FT SECTION: MINIMUM 2 HANGER POINTS
  - CONTINUOUS RUN: MINIMUM 2 HANGER POINTS PER 4' SECTION IS RECCOMENDED.
  - USE LS-YCABLE AT ALL FIXTURE JOINT LOCATIONS, 1 "Y" TO EACH FIXTURE IN THE RUN FOR SUPPORT.
  - USE LS-CABLEKIT SINGLE TOGGLES FOR THE ENDS.
7. PASS LOOP SIDE OF CABLE OVER, AROUND AND UNDER STRUCTURE.
8. PASS STRAIGHT END OF CABLE THROUGH LOOP AND PULL TIGHT.
9. RAISE FIXTURE WITH TOGGLE AND GRIPPER TO LOOP CABLE SECURED TO STRUCTURE.
10. PASS STRAIGHT END OF LOOP CABLE THROUGH TOGGLE. PLUNGER ON TOP OF TOGGLE CATCHES AND HOLDS CABLE SECURELY.
11. LEVEL FIXTURE PLUMB WITH BUILDING LINES. (TO LET OUT CABLE, PUSH PLUNGER DOWN).
12. MAKE FINAL WIRING CONNECTIONS. REFER TO "MAKING ELECTRICAL CONNECTIONS".

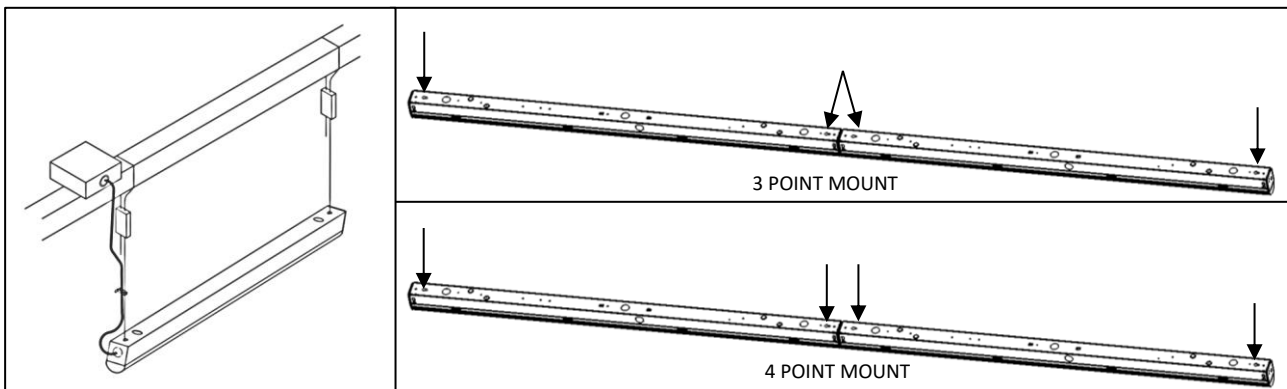



**IMPORTANT:** READ ALL INSTRUCTIONS THOROUGHLY AND CAREFULLY PRIOR TO INSTALLATION OF LINEAR SERIES FIXTURES AND RETAIN FOR FUTURE REFERENCE.

## INSTALLING SURFACE MOUNT (FXT and LNK):

1. SEE GENERAL INSTRUCTIONS AT THE FRONT OF THIS SECTION.
2. **CONTINUOUS RUN:** FOLLOW "JOINING FIXTURE SECTIONS" INSTRUCTIONS.
3. AC POWER MAY BE FOUND INSTALLED INTO THE BACK, MIDDLE OR SIDE OF THE FIXTURE. ADJUST AC POWER LOCATION, IF APPLICABLE.
4. CHOOSE A SUITABLE KNOCKOUT LOCATION FROM THOSE PROVIDED. REMOVE THE KNOCKOUT WITH A SCREWDRIVER.
5. REMOVE LED LIGHT COVER. (REFER TO SECTION "REMOVING LED COVER OF THIS INSTRUCTION.)
6. LIFT FIXTURE HOUSING TO CEILING AND MARK THE MOUNTING KEYHOLES WITH A PENCIL.
7. PULL EXISTING AC POWER FROM BUILDING THROUGH KNOCKOUT LOCATION INTO FIXTURE HOUSING. PROVIDE UL APPROVED STRAIN RELIEF (NOT PROVIDED) AS REQUIRED.
8. RAISE FIXTURE HOUSING TO SURFACE AND SECURE WITH APPROPRIATE CONNECTOR(S).
9. MAKE FINAL WIRING CONNECTIONS. REFER TO "MAKING ELECTRICAL CONNECTIONS".

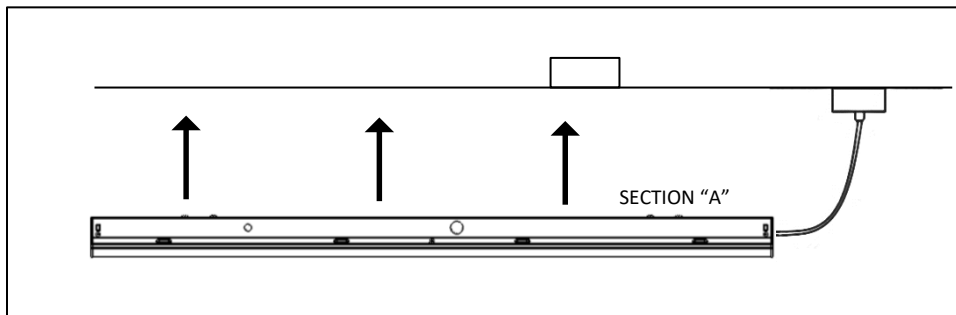
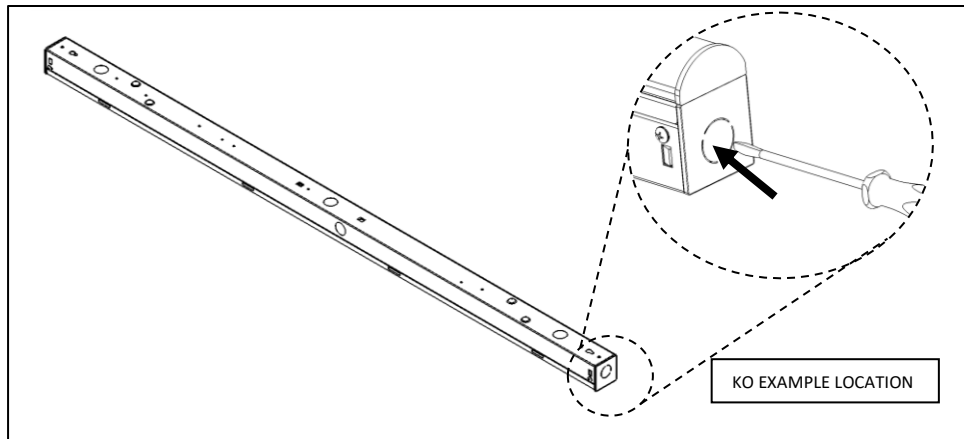



**IMPORTANT:** READ ALL INSTRUCTIONS THOROUGHLY AND CAREFULLY PRIOR TO INSTALLATION OF LINEAR SERIES FIXTURES AND RETAIN FOR FUTURE REFERENCE.

## MAKING ELECTRICAL CONNECTIONS:

### TURN OFF POWER AT PANEL OR BREAKER

#### STAND-ALONE FIXTURE (FXT):

- FIXTURES WITH OPTIONAL FACTORY-INSTALLED CORD WITH WIRE ENDS (WITHOUT PLUG):** EXTEND CORD AND WIRE ENDS TO NEAREST ELECTRICAL JUNCTION BOX (PROVIDED BY CONTRACTOR) AND MAKE FINAL ELECTRICAL CONNECTIONS PER ALL APPLICABLE CODES INSIDE JUNCTION BOX -BLACK TO BLACK (HOT); WHITE TO WHITE (NEUTRAL) AND GREEN (OR BARE) TO GREEN (GROUND); VIOLET TO VIOLET AND GREY TO GREY ON 5-WIRE CORD (IF APPLICABLE).

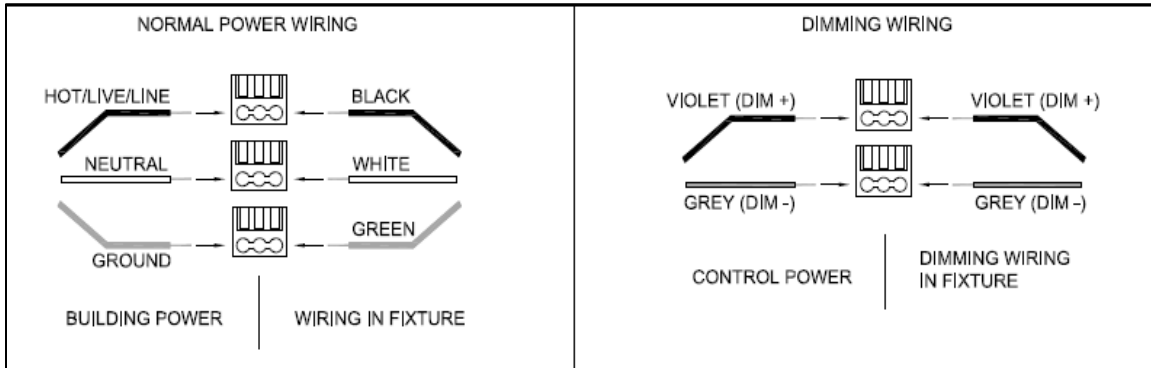

- FIXTURES WITH OPTIONAL FACTORY-INSTALLED CORD AND PLUG:** CONNECT CORD AND PLUG TO NEAREST APPROPRIATELY RATED RECEPTACLE (PROVIDED BY CONTRACTOR).

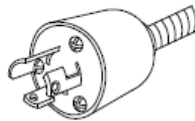
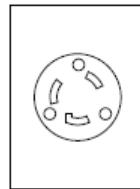

OPTIONAL CORD/PLUG (ORDERED SEPARATELY). PLUG INTO CONTRACTOR PROVIDED RECEPTACLE. THE CORD YOU ORDERED MAYBE BE DIFFERENT THAN THE CORD SHOWN HERE.

#### 3. HARDWIRED FIXTURES:

- REMOVE LED LIGHT COVER, SEE "REMOVING LED LIGHT COVER (FXT AND LNK)" IN THIS INSTRUCTION.
- TAKE NOTE WHERE DRIVER IS LOCATED IN LED CHASSIS.
- CHOOSE A SUITABLE KNOCKOUT LOCATION FROM THOSE PROVIDED IN FIXTURE HOUSING.
- REMOVE THE KNOCKOUT WITH A SCREWDRIVER.
- PULL EXISTING AC POWER FROM BUILDING THROUGH KNOCKOUT LOCATION INTO FIXTURE HOUSING. PROVIDE UL APPROVED STRAIN RELIEF (NOT PROVIDED) AS REQUIRED.

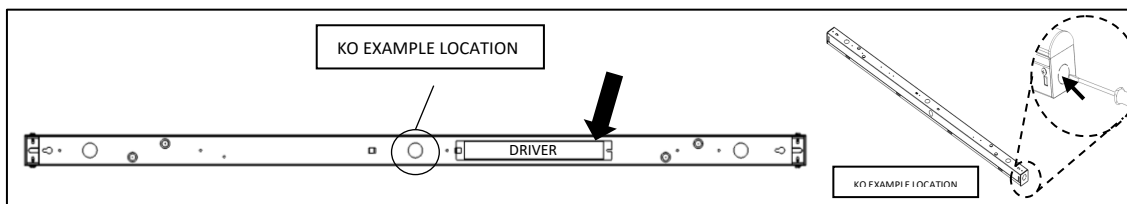



**IMPORTANT:** READ ALL INSTRUCTIONS THOROUGHLY AND CAREFULLY PRIOR TO INSTALLATION OF LINEAR SERIES FIXTURES AND RETAIN FOR FUTURE REFERENCE.

## HARDWIRED FIXTURES, CONT.:

### 4. MAKE ELECTRICAL CONNECTIONS PER ALL APPLICABLE CODES:

- NORMAL POWER WIRING - BLACK TO BLACK (HOT); WHITE TO WHITE (NEUTRAL) AND GREEN (OR BARE) TO GREEN (GROUND). ENSURE NO BARE WIRES ARE EXPOSED.
- DIMMING WIRING – VIOLET TO VIOLET (DIM +); GREY TO GREY (DIM -).
- EMERGENCY WIRING (WITH SWITCH LEG) - BLACK TO BLACK (HOT); BLACK (THIS MUST BE SUPPLIED BY AND RUN BY A QUALIFIED LOCAL ELECTRICIAN TO FIXTURE WITH EMB DRIVER IF IT IS NOT THE POWER DROP FIXTURE) TO RED (SWITCH); WHITE TO WHITE (NEUTRAL) AND GREEN (OR BARE) TO GREEN (GROUND). ENSURE NO BARE WIRES ARE EXPOSED.
- EMERGENCY WIRING (WITHOUT SWITCH LEG) - BLACK TO BLACK (HOT) AND BLACK TO RED (SWITCH) (SAME CONNECTOR); WHITE TO WHITE (NEUTRAL) AND GREEN (OR BARE) TO GREEN (GROUND). ENSURE NO BARE WIRES ARE EXPOSED.
- IF WIRING EMB WITH WIRING THROUGH MULTIPLE FIXTURES (CONTINUOUS RUN), MAX AMBIENT ON ALL FIXTURES IS 40°C.

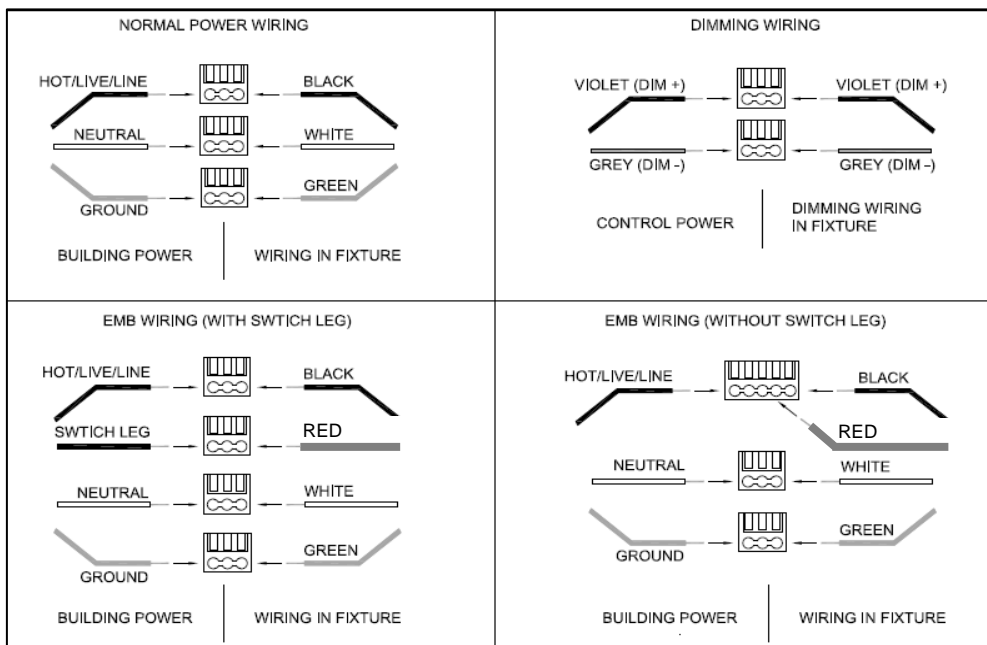

5. ELECTRICALLY ATTACH LED LIGHT COVER TO FIXTURE HOUSING USING THE QUICK CONNECTOR. NEATLY ARRANGE THE WIRES AND ENSURE ALL THE WIRES AND CONNECTIONS ARE SEALED PROPERLY INSIDE THE FIXTURE HOUSING. TAKE CARE NOT TO PINCH ANY WIRES.
6. ATTACH LED LIGHT COVER BY RAISING IT TO THE CHASSIS AND SNAPPING IN PLACE.
7. INSERT SAFETY SCREW (PROVIDED).
8. REMOVE PLASTIC FILM FROM LENS.
9. TURN ON ELECTRICITY AT THE CIRCUIT BREAKER, PANELBOARD, OR FUSE BOX.

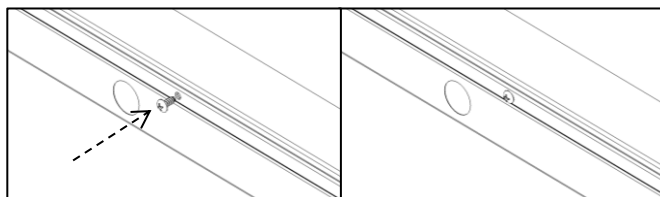
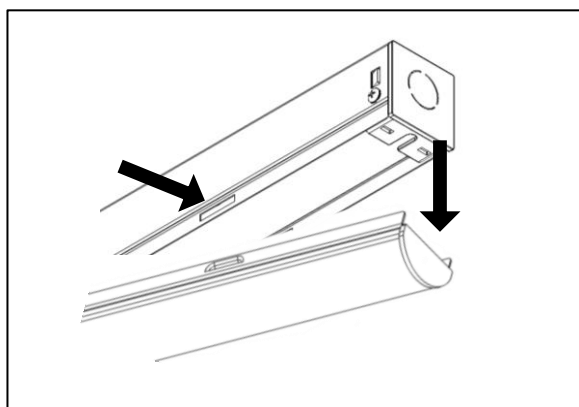



**IMPORTANT:** READ ALL INSTRUCTIONS THOROUGHLY AND CAREFULLY PRIOR TO INSTALLATION OF LINEAR SERIES FIXTURES AND RETAIN FOR FUTURE REFERENCE.

## MAKING ELECTRICAL CONNECTIONS:

### TURN OFF POWER AT PANEL OR BREAKER

#### STAND-ALONE FIXTURES WITH OCC/CTRL OPTIONAL ACCESSORIES (FXT):

1. WIRE FXT AS ABOVE. See **STAND-ALONE FIXTURE (FXT):**
2. REMOVE ENDCAP FROM FIXTURE.
3. INSERT THE ACCESSORY OCC/CTRL INTO THE END OF THE FIXTURE.
4. MAKE FINAL ELECTRICAL CONNECTIONS PER ALL APPLICABLE CODES INSIDE JUNCTION BOX -BLACK TO BLACK (HOT); WHITE TO WHITE (NEUTRAL) AND GREEN (OR BARE) TO GREEN (GROUND); VOILET TO VIOLET AND GREY TO GREY ON 5-WIRE CORD (IF APPLICABLE).
5. ELECTRICALLY ATTACH LED LIGHT COVER TO FIXTURE HOUSING USING THE QUICK CONNECTOR. NEATLY ARRANGE THE WIRES AND ENSURE ALL THE WIRES AND CONNECTIONS ARE SEALED PROPERLY INSIDE THE FIXTURE HOUSING. TAKE CARE NOT TO PINCH ANY WIRES.
6. ATTACH LED LIGHT COVER BY RAISING IT TO THE CHASSIS AND SNAPPING IN PLACE.
7. INSERT SAFETY SCREWS (PROVIDED).
8. REMOVE PLASTIC FILM FROM LENS.
9. TURN ON ELECTRICITY AT THE CIRCUIT BREAKER, PANELBOARD, OR FUSE BOX.

## MAKING ELECTRICAL CONNECTIONS:

### TURN OFF POWER AT PANEL OR BREAKER

#### LINKING FIXTURES (LNK):

POWER MAY BE BROUGHT INTO ANY FIXTURE IN THE RUN.

WHEN LINKING FIXTURES IN A CONTINUOUS RUN, A MAX OF 15 LINKED FIXTURES PER POWER DROP IS ALLOWED.

1. **FIXTURES WITH OPTIONAL FACTORY-INSTALLED CORD WITH WIRE ENDS (WITHOUT PLUG):** EXTEND CORD AND WIRE ENDS TO NEAREST ELECTRICAL JUNCTION BOX (PROVIDED BY CONTRACTOR) AND MAKE FINAL ELECTRICAL CONNECTIONS PER ALL APPLICABLE CODES INSIDE JUNCTION BOX -BLACK TO BLACK (HOT); WHITE TO WHITE (NEUTRAL) AND GREEN (OR BARE) TO GREEN (GROUND); VOILET TO VIOLET AND GREY TO GREY ON 5-WIRE CORD (IF APPLICABLE).

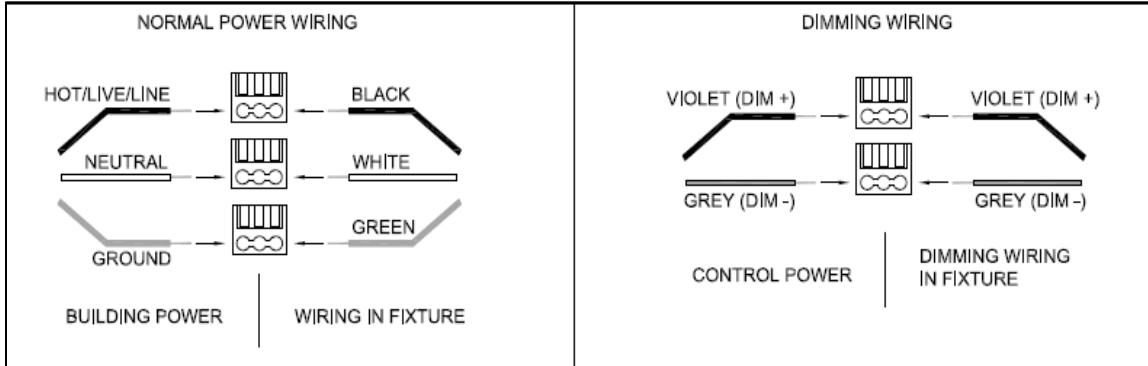

2. **FIXTURES WITH OPTIONAL FACTORY-INSTALLED CORD AND PLUG:** CONNECT CORD AND PLUG TO NEAREST APPROPRIATELY RATED RECEPTACLE (PROVIDED BY CONTRACTOR).

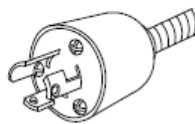
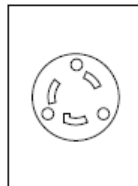

OPTIONAL CORD/PLUG (ORDERED SEPARATELY). PLUG INTO CONTRACTOR PROVIDED RECEPTACLE. THE CORD YOU ORDERED MAYBE BE DIFFERENT THAN THE CORD SHOWN HERE.





**IMPORTANT:** READ ALL INSTRUCTIONS THOROUGHLY AND CAREFULLY PRIOR TO INSTALLATION OF LINEAR SERIES FIXTURES AND RETAIN FOR FUTURE REFERENCE.

### 3. HARDWIRED FIXTURES (LNK):

- REMOVE LED LIGHT COVER, SEE "REMOVING LED LIGHT COVER (FXT AND LNK)" IN THIS INSTRUCTION.
- TAKE NOTE WHERE DRIVER IS LOCATED IN LED CHASSIS.
- CHOOSE A SUITABLE KNOCKOUT LOCATION FROM THOSE PROVIDED IN FIXTURE HOUSING.
- REMOVE THE KNOCKOUT WITH A SCREWDRIVER.
- PULL EXISTING AC POWER FROM BUILDING THROUGH KNOCKOUT LOCATION INTO FIXTURE HOUSING. PROVIDE UL APPROVED STRAIN RELIEF (NOT PROVIDED) AS REQUIRED.

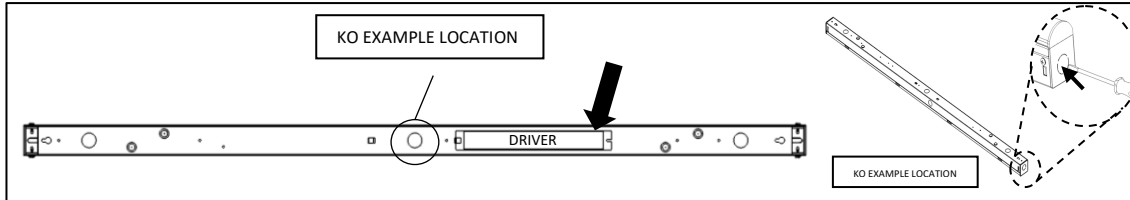

### 4. MAKE ELECTRICAL CONNECTIONS PER ALL APPLICABLE CODES:

- NORMAL POWER WIRING - BLACK TO BLACK (HOT); WHITE TO WHITE (NEUTRAL) AND GREEN (OR BARE) TO GREEN (GROUND). ENSURE NO BARE WIRES (OTHER THAN GROUND) ARE EXPOSED.
- DIMMING WIRING - VIOLET TO VIOLET (DIM +); GREY TO GREY (DIM -).
- LNK FIXTURE WIRING HARNESS DOES NOT EXTEND EMB SUPPLY WIRE. THIS MUST BE SUPPLIED BY AND RUN BY A QUALIFIED LOCAL ELECTRICIAN TO FIXTURE WITH EMB DRIVER IF IT IS NOT THE POWER DROP FIXTURE.
- EMERGENCY WIRING (WITH SWITCH LEG) - BLACK TO BLACK (HOT); BLACK TO BLACK/RED STRIPE (SWITCH); WHITE TO WHITE (NEUTRAL) AND GREEN (OR BARE) TO GREEN (GROUND). ENSURE NO BARE WIRES ARE EXPOSED.
- EMERGENCY WIRING (WITHOUT SWITCH LEG) - BLACK TO BLACK (HOT) AND BLACK TO BLACK/RED STRIPE (SWITCH) (SAME CONNECTOR); WHITE TO WHITE (NEUTRAL) AND GREEN (OR BARE) TO GREEN (GROUND). ENSURE NO BARE WIRES ARE EXPOSED.
- IF WIRING EMB WITH WIRING THROUGH MULTIPLE FIXTURES (CONTINUOUS RUN), MAX AMBIENT ON ALL FIXTURES IS 40°C.

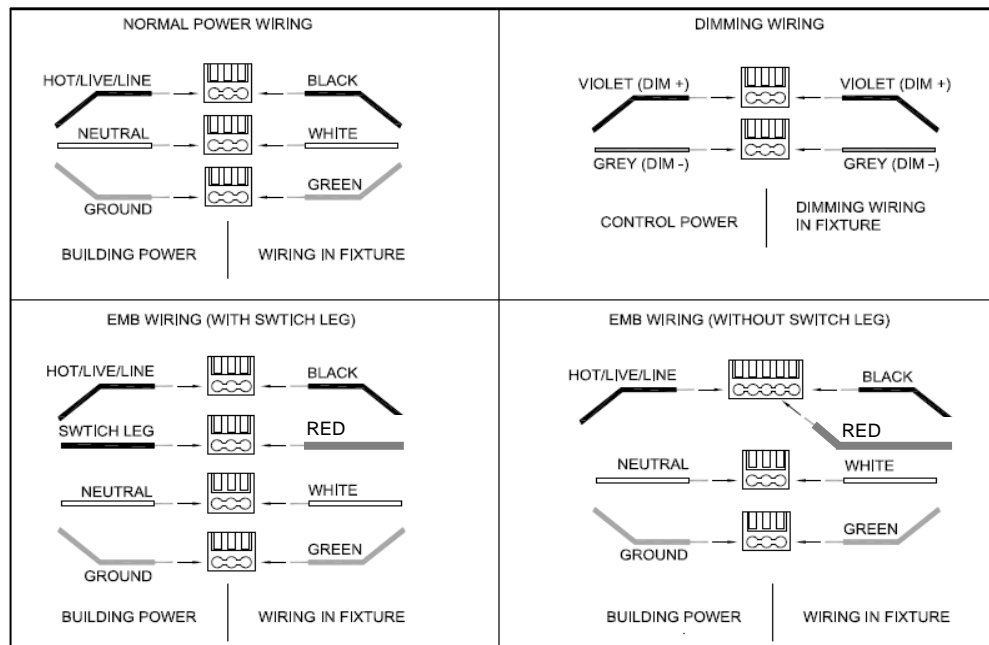

- ELECTRICALLY ATTACH LED LIGHT COVER TO FIXTURE HOUSING USING THE QUICK CONNECTOR. NEATLY ARRANGE THE WIRES AND ENSURE ALL THE WIRES AND CONNECTIONS ARE SEALED PROPERLY INSIDE THE FIXTURE HOUSING. TAKE CARE NOT TO PINCH ANY WIRES.
- ATTACH LED LIGHT COVER BY RAISING IT TO THE CHASSIS AND SNAPPING IN PLACE.
- INSERT SAFETY SCREWS (PROVIDED).
- REMOVE PLASTIC FILM FROM LENS.
- TURN ON ELECTRICITY AT THE CIRCUIT BREAKER, PANELBOARD, OR FUSE BOX.

### HARDWIRED FIXTURES (LNK), CONT.:

#### 10. (LNK) LINKING SECTIONS TOGETHER:

- EACH LNK FIXTURE COMES WITH THE MECHANICAL JOINING PIECE (LS-MJP) INSTALLED ON ONE END FOR MECHANICAL CONNECTION.





**IMPORTANT: READ ALL INSTRUCTIONS THOROUGHLY AND CAREFULLY PRIOR TO INSTALLATION OF LINEAR SERIES FIXTURES AND RETAIN FOR FUTURE REFERENCE.**

- A WIRE HARNESS ELECTRICALLY CONNECTS EACH SECTION VIA QUICK CONNECTORS.
  - EACH CONNECTOR IS KEYED, IT WILL ONLY FIT ONE WAY.
  - EACH FIXTURE HAS A "JUMPER" ON ONE END OF THE WIRING HARNESS. IT IS FACTORY INSTALLED.
  - THE "JUMPER" MUST BE REMOVED FROM THE END OF ONE FIXTURE BEFORE THE NEXT FIXTURE IS CONNECTED. DISPOSE OF PROPERLY.
  - THE "JUMPER" MUST REMAIN CONNECTED TO THE WIRING HARNESS ON ONE END OF THE FIXTURE RUN.
  - MAX 15 LINKED FIXTURES PER POWER DROP.
  - CONNECT EACH SECTION TO THE OTHER USING THE QUICK CONNECTORS. PLUG QUICK DISCONNECT FROM ONE SECTION INTO QUICK DISCONNECT ON THE NEXT SECTION. REPEAT UNTIL ALL FIXTURES ARE CONNECTED. **REMEMBER THE "JUMPER" MUST REMAIN CONNECTED TO THE WIRING HARNESS ON ONE END OF THE FIXTURE RUN.**
  - THE LED LIGHT COVER NEED NOT BE REMOVED FOR INSTALLATION OF EACH SUBSEQUENT LNK FIXTURE.
11. TURN ON ELECTRICITY AT THE CIRCUIT BREAKER, PANELBOARD, OR FUSE BOX.
  12. REMOVE PLASTIC FILM FROM LENS.
  13. TURN ON ELECTRICITY AT THE CIRCUIT BREAKER, PANELBOARD, OR FUSE BOX.

## **LINKING FIXTURES WITH OCC/CTRL OPTIONAL ACCESSORIES (LNK):**

THE OCC/CTRL-LNK ACCESSORIES MAY BE INSTALLED ANYWHERE IN THE RUN OF LINKING FIXTURES.

THE OCC/CTRL-LNK ACCESSORIES WILL CONTROL THE LIGHTS IN THE ENTIRE RUN IN WHICH IT IS CONNECTED. UNLESS THE SENSOR STOP (LS-SNSRSTOP) ACCESSORY IS USED.

**ALL "JUMPERS" MUST BE REMOVED FROM ALL LNK FIXTURES WHEN USING AN OCC/CTRL-LNK ACCESSORY.** DISPOSE OF PROPERLY.

1. WIRE LNK AS ABOVE. See **LINKING FIXTURES (LNK):**
2. LINKING SECTIONS TOGETHER:
  - THE LED LIGHT COVER NEED NOT BE REMOVED FOR INSTALLATION OF THE ACCESSORY OCC/CTRL.
  - EACH OCC/CTRL-LNK ACCESSORY COMES WITH THE MECHANICAL JOINING PIECE (LS-MJP) INSTALLED ON ONE END AND AN END CAP ON THE OTHER.
  - A WIRE HARNESS ELECTRICALLY CONNECTS EACH ACCESSORY TO THE FIXTURE SECTION VIA QUICK CONNECTOR(S).
  - EACH CONNECTOR IS KEYED, IT WILL ONLY FIT ONE WAY.
- EACH FIXTURE HAS A "JUMPER" ON ONE END OF THE WIRING HARNESS. IT IS FACTORY INSTALLED.
- **ALL "JUMPERS" MUST BE REMOVED FROM ALL LNK FIXTURES WHEN USING AN OCC/CTRL-LNK ACCESSORY.** DISPOSE OF PROPERLY.
  - EITHER THE END CAP OR THE MECHANICAL JOINING PIECE (LA-MJP) INCLUDED ON THE OCC/CTRL ACCESSORY WILL BE DISPOSED OF UPON INSTALLATION, DEPENDING ON CONFIGURATION. DISPOSE OF PROPERLY.
3. REMOVE ENDCAP OR MECHANICAL JOINING PIECE (LS-MJP) FROM THE END OF FIXTURE YOU WISH TO JOIN TO THE ACCESSORY. REMOVE THE SCREWS AND ALSO DEPRESS THE TABS HOLDING IN THE END CAP. DISPOSE OF PROPERLY.
4. MAKE FINAL ELECTRICAL CONNECTIONS BY CONNECTING EACH SECTION TO THE OTHER USING THE QUICK CONNECTORS.
  - INSERT THE ACCESSORY OCC/CTRL INTO THE END OF THE FIXTURE.
  - REPEAT UNTIL ALL FIXTURES ARE CONNECTED.
5. TURN ON ELECTRICITY AT THE CIRCUIT BREAKER, PANELBOARD, OR FUSE BOX.

## **LINKING FIXTURES (LNK) WITH SENSOR STOP FEATURE (SNSRSTOP):**

- SENSOR STOP (LS-SNSRSTOP) IS A WIRE HARNESS ELECTRICALLY CONNECTS EACH ACCESSORY TO THE FIXTURE SECTION VIA QUICK CONNECTOR(S).
- EACH SENSOR STOP (LS-SNSRSTOP) CONNECTOR IS KEYED, IT WILL ONLY FIT ONE WAY.

THE SENSOR STOP (LS-SNSRSTOP) ALLOWS POWER TO GO THROUGH, NOT THE CONTROL SIGNAL FROM THE OCC/CTRL-LNK ACCESSORY.

THE SENSOR STOP FEATURE (LS-SNSRSTOP) ALLOWS CONTROL TO BE SPLIT AMONG LINKED (LNK) FIXTURES CONNECTED IN A CONTINUOUS RUN. SOME MAY BE CONTROLLED BY THE OCC/CTRL-LNK ACCESSORY WHILE THE OTHERS ARE NOT, STILL ALLOWING POWER TO BE SENT TO THE OTHER FIXTURES.

EXAMPLE: THERE IS A 10 FIXTURE RUN DOWN AN AISLE, AND YOU WANT THE FIRST FIVE FIXTURES TO BE ON ALL THE TIME, BUT THE LAST FIVE TO BE CONTROLLED BY AN OCCUPANCY SENSOR PLACED IN THE MIDDLE OF THE ROW.

MULTIPLE LS-OCC##-LNK ACCESSORIES MAY BE USED IN A SINGLE CONTINUOUS RUN. WHEN ANY SENSOR IS TRIGGERED, THE ENTIRE ROW WILL BE CONTROLLED. CONTROLLED FIXTURES MUST BE IN SEQUENCE WITH THE OCCDIM##-LNK OR LS-CTRL-LNK ACCESSORY IN INSTALLATION. ONLY ONE SENSOR PER ROW PERMITTED.

1. WIRE LNK AS ABOVE. SEE **LINKING FIXTURES WITH OCC/CTRL OPTIONAL ACCESSORIES (LNK):**
2. DURING THE INSTALLATION PLACE THE SENSOR STOP ACCESSORY (SNSRSTOP) AT THE LAST FIXTURE YOU WANT TO CONTROL.
  - PLUG SENSOR STOP (LS-SNSRSTOP) QUICK DISCONNECT FROM ONE SECTION INTO QUICK DISCONNECT ON THE NEXT SECTION.
  - CONTINUE INSTALLING FIXTURES UNTIL COMPLETE.
3. TURN ON ELECTRICITY AT THE CIRCUIT BREAKER, PANELBOARD, OR FUSE BOX.

