

PROJECT NAME		DATE	
CAT. NUMBER			
NOTES			

SPEC SHEET

Ace LED Strip (AS2)

LED STRIP FIXTURE



Sensor sold separately



Projected L70 up to 150,000 hours

KEY FEATURES

- 2ft, 4ft and 8ft Lengths Available
- 1,300 to 11,700 Lumens
- Up to 130 LPW
- Selectable CCT: (3500K, 4000K, 5000K)
- Selectable Output Power: 25W to 90W
- Frosted Lens
- Low Glare



Selectable Wattage

Each fixture has a switch with three output power options, allowing to select the desired lumen output and energy consumption for each application.



Selectable Color Temperature

Simply use the switch directly on the fixture to select the desired color temperature for your space: 3500K, 4000K, or 5000K.

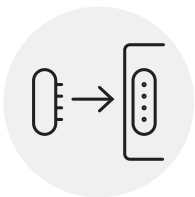

EZ-Connect™ Receptacle

The simplest and fastest way to add sensors and UltraLink wireless controls at any time in the field. Snap-in system, no tools or wiring needed.

FEATURES & SPECIFICATIONS

CONSTRUCTION

- **Housing:** Steel. Low profile design.
- **Housing Color:** White.
- **Length:** 2ft, 4ft, and 8ft models available.
- **Hinges:** Toolless access for easy wiring and maintenance.
- **Knockouts:** One 1/2" NPT knockout on each side.
- **Fixture Linking:** Supported, requires rewiring.
- **EZ-Connect™ Receptacle:** The simplest and fastest way to add sensors and wireless controls at any time on the field. Snap-in system, no tools or wiring needed.

ELECTRICAL

- **Power Input:** 120-277V (50/60Hz).
- **Power Factor:** Greater than 0.9.
- **Total Harmonic Distortion:** Less than 20%.
- **Emergency Battery Backup:** EMB has 9 watts output, producing ~1,100 lumens for 90 minutes. Sold as an accessory (field installed).

OPERATION

- **Environment:** For interior applications, dust-resistant, listed for damp locations.
- **Ambient Range Operation:** -20°C up to 40°C (-4°F up to 104°F).

OPTICS

- **CCT:** Selectable via switch 3500K, 4000K, 5000K.
- **CRI:** 80+ standard.
- **Lens:** PC diffuser. Frosted. 134° beam angle.

MOUNTING

- **Surface Mount:** Standard.
- **Suspension Mount:** Suspended mount kit available as an accessory.



CONTROLS¹

- **Dimming:** 0-10V standard. Dim to Off. Dimming range 100% to 5%.
- **Occupancy Sensors:** PIR sensor, On/Off/Dim. EZ-Connect™ Snap-in system for field installation.
- **Networked Lighting Controls:** UltraLink Wireless Controls with Bluetooth® NLC Mesh technology. EZ-Connect™ Snap-in system for field installation.

WARRANTY

- **5 Year Warranty:** The fixture is guaranteed for 5 years free of defects in materials and workmanship, including LEDs and driver. "Defective" is considered if ten percent (10%) or more of the LEDs, per product, are non-operating LEDs, or color temperature has shifted more than 500° Kelvin within the warranty period. See terms and conditions at <https://linmoreled.com/warranty>

LISTINGS & CERTIFICATIONS

- UL listed.
- RoHS compliant.
- UL listed for damp locations.
- DesignLights™ Consortium Premium.

TECHNICAL SPECS

SIZE	WATTS	LUMEN OUTPUT	EFFICACY	PART NUMBER
2ft	10 / 15 / 20	1,300 / 1,950 / 2,600	130	AS20S-A2-ADJ-02-ADJ-80-FR-LV-FXT-EZ40-10V
4ft	25 / 35 / 45	3,250 / 4,500 / 5,800	130	AS20S-A2-ADJ-04-ADJ-80-FR-LV-FXT-EZ40-10V
8ft	65 / 75 / 90	8,500 / 9,750 / 11,700	130	AS20S-A2-ADJ-08-ADJ-80-FR-LV-FXT-EZ40-10V

Typical lumen output (±10%) at 5000K CCT and 277V (LV) under 25°C ambient temperature.

Selectable Wattage and Color Temperature

Fixtures ship from the factory with the highest wattage and 5000K CCT, to change these settings:

1. Make sure the fixture is off.
2. Adjust the dip switches located on the driver inside the fixture to select output power and color temperature.

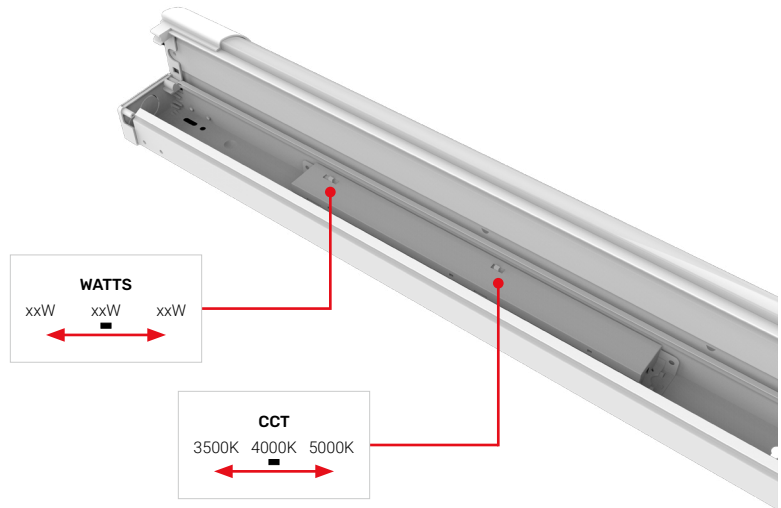

ORDERING

SERIES MODEL - COMPLIANCE - WATTS - SIZE AS20S-A2-ADJ-02 AS20S-A2-ADJ-04 AS20S-A2-ADJ-08	COLOR TEMP ADJ Adjustable/Selectable: 3500K, 4000K, 5000K	CRI 80 80+ CRI	LENS FR Frosted lens	VOLTAGE LV 120-277V
MOUNTING FXT Full fixture Mounting kits sold separately, see Accessories	CONTROLS¹ EZ40 EZ-Connect™ Receptacle with Snap-in system (standard) Sensors not included, see Controls pages for available products	DIMMING 10V 0-10V		

Ordering Example: AS20S-A2-ADJ-04-ADJ-80-FR-LV-FXT-EZ40-10V

ACCESSORIES

Must be ordered separately. Packaged separately.

FIXTURE ACCESSORIES

Part Number	Type	Description
CABLEKIT-TE	Cable Kit	Kit includes two cables and two toggle hangers.
AS20S-SPMK	Suspended Mount Kit	Suspended Mount Kit. Includes two V-Hooks and two 3.2ft chains.
AS20S-JOIN	Joiner Bracket	Fixture Joiner Bracket. Only required when joining suspended mounted fixtures.
AS2-EMB-09W	Emergency Battery Driver	Emergency Backup Driver with Battery, 9W, ~1,100 lumens for 90 minutes. Field installed. Ships in a separate box.

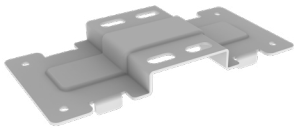

Joiner Bracket



Suspended Mount Kit

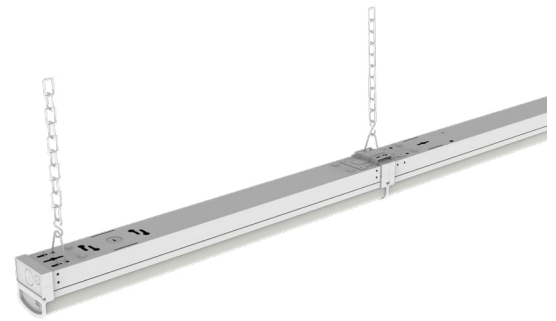



Two fixtures with Suspended Mount Kit and Joiner Bracket

BASIC CONTROLS

Controls are field installed, must be ordered as a new line item and will ship in a separate box.

BASIC SENSORS¹

	Part Number	Description
	PIR-WH-EZ40	PIR Occupancy and Daylight Sensor, EZ-Connect Snap-in System, Plug & Play, On/Off/Dim, 12' Max Mounting Height, IP20. Field installed. Sensor can be re-programmed with remote SEN-PROG (sold separately).
	SEN-PROG	Infrared Remote Programmer for Occupancy Sensors. Required to change default settings and modes of operation.

DEFAULT SETTINGS

Sensitivity=100%, Hold time=5min, Daylight sensor=disabled, Stand-by dim level=30%, Stand-by time=60min.

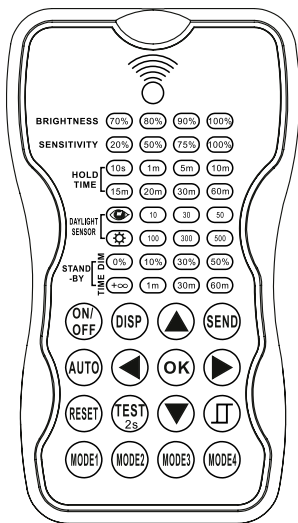

INFRARED REMOTE PROGRAMMER

Required to change default settings and modes of operation.

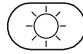
Brightness	Light output during occupancy (70%, 80%, 90%, 100%).		Daylight harvesting function. Selects the current surrounding lux value as the daylight threshold.
Sensitivity	Detection area of the sensor (20%, 50%, 75%, 100%).		Daylight sensor disabled. All motion detected turns on the light, no matter how bright the natural light is.
Hold Time	Time the sensor waits to turn off or dim the light after the area is vacated.	Stand-by Dim	Light output during vacancy (0%, 10%, 30%, 50%).
Daylight Sensor	Daylight sensor status and daylight threshold values in lux.	Stand-by Time	Time the sensor keeps the light at stand-by dim level after the hold time has elapsed.

Scene Modes

The remote comes with four preprogrammed modes. These can be used as is, or adjusted with different parameters and saved over an existing mode.



Scene	Application	Brightness	Sensitivity	Hold Time	Stand-by Dim	Stand-by Time	Daylight Sensor
MODE 1	Indoor	100%	75%	5min	30%	30min	Disabled
MODE 2	Indoor	100%	75%	1min	30%	+∞	Disabled
MODE 3	Indoor	100%	75%	5min	30%	30min	30lux
MODE 4	Outdoor	100%	75%	1min	30%	+∞	30lux/300lux

ULTRALINK BLUETOOTH CONTROLS









Controls are field installed, must be ordered as a new line item and will ship in a separate box.

ULTRALINK CONTROLLERS / SENSORS¹

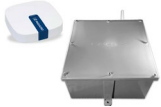
Part Number	Description
 ULTRAPIR-WH-EZ40	UltraLink Bluetooth NLC Wireless Fixture Controller with PIR Occupancy and Daylight Sensor, White Color, EZ-Connect Snap-in System, 12' Max Mounting Height, IP20, Silvair Firmware. Field installed.
 SEN-PROG	Infrared Remote Programmer for Occupancy Sensors. Only required for EZ10 UltraLink sensors to change detection sensitivity.

ULTRALINK ACCESSORIES

Part Number	Description
 ULTRAGATEWAY	UltraLink Bluetooth NLC Wireless Gateway, required for Advanced Features and Time-Based Events. One gateway can control up to 200 fixtures, allowing for energy monitoring, people tracking, and scheduling. Interior installation only.
 ULTRAGATEWAY-4G	UltraLink Bluetooth NLC Wireless Gateway, RJ45 Ethernet Connector and SIM Card Slot for 4G Cellular Connectivity, PoE or 120V AC Power Adapter, Long Range Bluetooth Mesh, Hardware Security Module, Encrypted File System, Secure Boot, Interior installation only.
 ULTRAGATEWAY-EXT	UltraLink Bluetooth NLC Wireless Exterior Rated Gateway Box with Long Range Antenna, includes ULTRAGATEWAY. 120-277V Power Supply required.
 ULTRAGATEWAY-EXT-4G	UltraLink Bluetooth NLC Wireless Exterior Rated Gateway Box with Long Range Antenna and 4G Cellular Connectivity. Includes ULTRAGATEWAY-4G in a Vented, Temperature-Controlled NEMA Enclosure, Universal Voltage (120, 208, 240, 277, and 480V), Wall Mount, 24 Hour Battery Backup. Optional pole mount kit. Cellular data plans available.
 ULTRATIME-BAT	UltraLink Bluetooth NLC Time-Keeping Battery Backup includes an Outdoor Rated Enclosure, a Long Range Antenna and a Backup Battery. For use to keep time during a power outage and for in-node scheduling.
 ULTRADASH	UltraLink Dashboards for Energy, Occupancy Heat Mapping, and Energy Heat Mapping. Gateway (ULTRAGATEWAY) required, sold separately.

DIMENSIONS & DRAWINGS

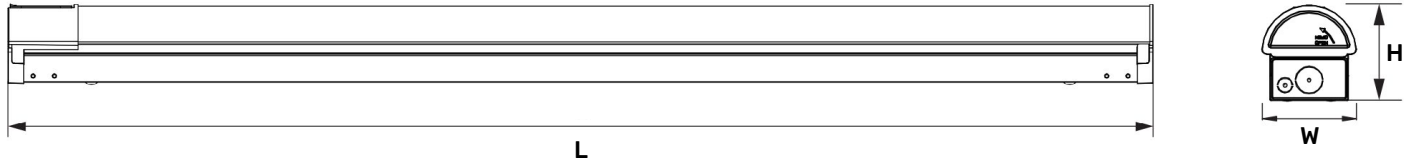

Size	L	W	H	Weight
2ft	23.94"	2.89"	2.95"	~1.8lbs
4ft	47.56"	2.89"	2.95"	~3.1lbs
8ft	94.80"	2.89"	2.95"	~6.2lbs

PHOTOMETRY

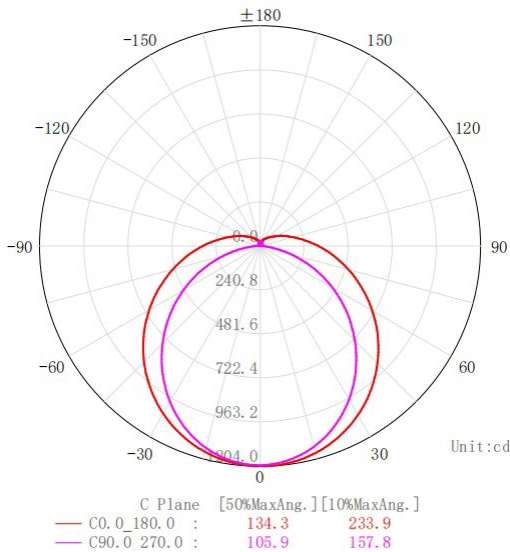

Dimension tolerances: ± 0.1". Weights are approximate, if weight is a concern, please contact factory.

FOOTNOTES

- The performance of sensors and lenses is influenced by various factors beyond Linmore LED's control, including but not limited to environmental conditions, user settings, and proper maintenance. While we provide detailed specifications and guidelines to help optimize performance, we cannot guarantee or be held liable for the performance of sensors or lenses under any particular circumstance(s). Customers are advised to test the products in their specific application environments to ensure suitability for their intended use and are responsible for all sensor and lens selections.

Linmore LED Labs, Inc.

2360 S Orange Ave, Fresno, CA 93725
 559 485 6010 | info@linmoreled.com | linmoreled.com



All specifications are subject to change without notice. Please visit linmoreled.com for latest information. All values are typical or design values and series averages. Actual performance may differ as a result of end-user environments and applications. Consult Linmore LED with specific inquiries. Copyright © 2025, Linmore LED Labs, Inc. All rights reserved. No part of this document may be reproduced in any form without the prior written permission of Linmore LED.