



LinmoreLED[®]
ULTRA PERFORMANCE LIGHTING

OUTDOOR LIGHTING GUIDE

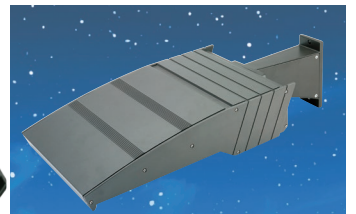
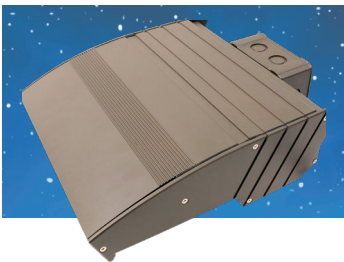

TABLE OF CONTENTS

5 SITE LIGHTER (SL1) SPEC SHEET

FIXTURE BRACKETS

- LL-SL1-RMB
9 Rapid Mount Bracket (U.S. Patent No. 10,845,039)
Universal bracket for round or square pole.
- LL-SL1-SA
10 Straight Arm Mount
Used for fixed horizontal applications.
- LL-SL1-A12
10 Round to Square Pole Adapter
To mount a Straight Arm Mount to a round pole. For use with Straight Arm Mount .
- LL-SL1-SF
11 Slip Fitter
Bracket used for vertical or horizontal, adjustable angle applications.
- LL-SL1-TM
11 Trunnion (Yoke) Bracket
To mount SL1 fixtures to multiple surfaces allowing the fixture to be installed in unique applications.

TENONS

- LL-SL1-A1
12 Vertical or Horizontal Tenon
For use with 4" and larger square poles or flat surfaces.
- LL-SL1-A2
12 Round Pole Horizontal Tenon
For use with round poles.
- LL-SL1-A3
13 Vertical or Horizontal Mount Tenon
For use with flat surfaces including walls and flooring providing a round pipe for mounting SL1
Fixtures with a Slip Fitter Bracket or adding Cross Arms.
- LL-SL1-A4
13 Vertical Wall Mount Tenon
For use with walls providing a vertical round pipe for mounting SL1 Fixtures with a Slip Fitter Bracket
or adding Cross Arms.
- LL-SL1-A10
14 Single-Fixture Multi-Mount Tenon
To add a round pipe for mounting SL1 Fixtures with a Slip Fitter Bracket to a variety of vertical and
horizontal surfaces creating unique options for fixture placement.

ADAPTERS

- LL-SL1-A5
15 Square Pole to Vertical Slip Fitter Adapter
Converts mounting 4" square pole to 2-3/8" O.D. vertical mount.

- LL-SL1-A6
15 Square Pole to Vertical Slip Fitter Adapter
 Converts mounting 5" square pole to 2-3/8" O.D. vertical mount.
- LL-SL1-A18
16 Square Pole to Vertical Slip Fitter Adapter
 Converts mounting 6" square pole to 2-3/8" O.D. vertical mount.
- LL-SL1-A7
16 Round Pole to Vertical Slip Fitter Adapter
 Converts mounting 4" round pole to 2-3/8" O.D. vertical mount.
- LL-SL1-A14
17 Round Pole to Vertical Slip Fitter Adapter
 Bracket reduces from 3" pole to 2-3/8" O.D.
- LL-SL1-A17
17 Clamp-On Mid-Pole Vertical Slip Fitter Adapter
 For use with 4"-5" square poles to provide a round vertical pipe for mounting SL1 Fixtures with a Slip Fitter Bracket at a position on the pole that is not the top.

CROSS ARMS

- LL-SL1-A8
18 Two Fixture Straight Cross Arm
 Adapts from single 2-3/8" O.D. to two vertical mounting locations, 2-3/8" at 28" on center apart.
- LL-SL1-A9
18 Three Fixture 120° Cross Arm
 Adapts from single 2-3/8" O.D. to three vertical mounting locations, 2-3/8" at 28" on center apart.
- LL-SL1-A11
19 Three Fixture Straight Cross Arm
 Adapts from single 2-3/8" O.D. to three vertical mounting locations, 2-3/8" at 28" on center apart.
- LL-SL1-A13
19 Four Fixture 90° Cross Arm
 Adapts from single 2-3/8" O.D. to four vertical mounting locations, 2-3/8" at 28" on center apart.
- LL-SL1-A15
20 Three Fixture 90° Cross Arm
 Adapts from single 2-3/8" O.D. to three vertical mounting locations at 28" on center apart.
- LL-SL1-A16
20 Two Fixture 90° Cross Arm
 Adapts from single 2-3/8" O.D. to two vertical mounting locations at 22.65" on center apart.

ACCESSORIES

- GSB
21 Glare Shield - Back
 Cut-off shield used on outdoor fixtures to direct light.
- GSS
21 Glare Shield - Side
 Cut-off shield used on outdoor fixtures to direct light.
- LL-SL1-A30
22 Spacer
 Pole Spacer

Finish Options:

Unless otherwise requested, the color of all Part Numbers in this Exterior Fixture Guide come in Standard Bronze. The Site Lighter Series fixtures are available in the following standard colors. Standard Bronze, Black, or White.

STANDARD BRONZE	Alesta® CPC Gray Mini Tex PFHF324T0
BLACK	Alesta® Matte Black II UFB655S2
GRAY	RAL 7045 Telegrey 1
WHITE	Tiger Drylac™ White Matte 049/1135

Legal Notice:

The customer is solely responsible for proper selection of the pole, luminaire, and accessories for the given site conditions and intended usage. Linmore LED Labs, Inc. assumes no liability for determining weight limits or EPA compliance. Depending on the installation location, ice loads, may also need to be considered when calculating the total weight.

SPEC SHEET

Site Lighter (SL1)

EXTERIOR LED FIXTURE



KEY FEATURES

- Up to 174 LPW
- 8,500 to 62,000 lumens
- Up to 55°C
- 200-480V universal driver (optional)
- Dimmable 0-10V
- Expected life > 150,000 hours
- Patented Rapid Mount Bracket (optional)



10 Year Warranty

All parts of SL1 are covered for 10 years, including the driver.



Superior Heat Dissipation

Extruded aluminum body is exceptional at moving thermal energy. Plus, the aesthetics are modern and attractive.



Controls and Sensors

Linmore LED Driver with 0-10V dimming. Plus motion and dimming sensors, photo cell and wireless controls available.



TECHNICAL SPECS

Housing	Wattage	TYPE				FRONT ROW		FLOOD	
		T2	T3	T4	T5	FR	FL	F60	F35
SM	50W	8,676	8,676	8,598	8,676	8,676	8,676	8,439	8,336
SM	75W	12,284	12,284	12,161	12,284	12,284	12,284	11,916	11,793
SM	100W	16,729	16,729	16,562	16,729	16,729	16,729	16,227	16,060
MD	125W	21,176	21,176	20,965	21,176	21,176	21,176	20,541	20,329
MD	150W	24,397	24,397	24,153	24,397	24,397	24,397	23,665	23,421
MD	200W	30,980	30,980	30,670	30,980	30,980	30,980	30,051	29,741
LG	300W	46,935	46,935	46,465	46,935	46,935	46,935	45,527	45,057
XL	400W	62,341	62,341	61,718	62,341	62,341	62,341	60,471	59,847

Typical lumen output (±10%) at 120V (LV) under 25°C ambient temperature at 5000K.

Lumen Multipliers

Allows to calculate the actual lumen output for your application. Apply each multiplier to the lumens of the shaded table.

COLOR TEMP	
CCT	Multiplier
5000	1.000
4000	1.000
3500	0.980
3000	
2200	0.780

Example: How to calculate the actual lumen output of the model 21K at these conditions: 2200K.

- 1) Find the lumens from the shaded column.
- 2) Apply all the corresponding multipliers.

21,176

x

0.78

=

16,517

Nominal lumensCCTActual lumens

MODEL	WATTS	OPTIC	BUG RATE	OPTIC	BUG RATE	OPTIC	BUG RATE	OPTIC	BUG RATE
LL-SL1-SM-50WD	50	T5	B3-U0-G1	T4	B1-U0-G1	T3	B1-U0-G1	T2	B1-U0-G1
LL-SL1-SM-75WD	75	T5	B4-U0-G2	T4	B1-U0-G2	T3	B1-U0-G2	T2	B2-U0-G1
LL-SL1-MD-100WD	100	T5	B4-U0-G2	T4	B2-U0-G2	T3	B2-U0-G2	T2	B2-U0-G1
LL-SL1-MD-125WD	125	T5	B4-U0-G2	T4	B2-U0-G2	T3	B2-U0-G2	T2	B2-U0-G1
LL-SL1-MD-150WD	150	T5	B5-U0-G3	T4	B2-U0-G2	T3	B2-U0-G2	T2	B2-U0-G1
LL-SL1-MD-200WD	200	T5	B5-U0-G3	T4	B2-U0-G2	T3	B2-U0-G2	T2	B3-U0-G2
LL-SL1-MD-300WD	300	T5	B5-U0-G3	T4	B2-U0-G3	T3	B2-U0-G3	T2	B3-U0-G2
LL-SL1-XL-400WD	400	T5	B5-U0-G4	T4	B2-U0-G3	T3	B2-U0-G3	T2	B3-U0-G4

ORDERING

SERIES MODEL	HOUSING SIZE	WATTAGE (WD)	KELVIN	OPTIC	VOLTS
LL-SL1-	SM Small 50W, 75W, 100W only	50WD	22K⁹ 2200K	T2 Type 2	UNV 120-277V 0-10V dimming HV 200-480V 0-10V dimming
	MD Medium 125W, 150W, 200W only	75WD	30K⁹ 3000K	T3 Type 3	
	LG⁶ Large 300W only	100WD	35K 3500K	T4 Type 4	
	XL⁶ Extra Large 400W only	125WD	40K 4000K	T5 Type 5	
		150WD	50K 5000K	FR Front Row Right	
		200WD		FL Front Row Left	
		300WD		F35 Flood 35 degrees	
		400WD		F60 Flood 60 degrees	
		WD = wattage dimming			

GENERATION 2	HOUSING COLOR	MOUNTING	OPTIONS
G2	BRN Bronze	SF Slip Fitter Bracket	PC Photocell
	WH White	SA⁶ Standard Arm Bracket	PC-TL Photocell, Twist Lock, 120-277V or 480V depending on model.
	BLK Black	TM Trunnion Mount Bracket	QBM Linmore LED UltraLink
	CUS⁴ Custom (Special order)	RMB Rapid Mount Bracket	FSP-201 WattStopper 0-10V dimming sensor, 12V
			FSP-211 WattStopper 0-10V dimming sensor, 120-277V
			MCW-BLE McWong sensor for use with UltraLink only
			GSB Glare Shield Back
			GSS⁵ Glare Shield Side, contact factory
			SSP 20kA Surge Suppressor, 120-277V
			SSPH 20kA Surge Suppressor, 480V

ORDERING EXAMPLES

Standard: LL-SL1-MD-150WD-50K-T3-UNV-G2-BRN-SA

With Options: LL-SL1-MD-150WD-50K-T3-UNV-G2-BRN-SA-**QBM-GSB**

OPTIONS

OPTICS	
Part Number	Description
T2	Type 2 Optics
T3	Type 3 Optics
T4	Type 4 Optics
T5	Type 5 Optics
FL	Front Row Optics Left
FR	Front Row Optics Right
F35	Flood Optics 35 Degrees
F60	Flood Optics 60 Degrees
ACCESSORIES <small>*ORDERED SEPARATELY</small>	
Switches	
EO-ESRPB	Enocean switch. Single rocker with Bluetooth®.
EO-EDRPB	Enocean switch. Double rocker with Bluetooth®.

MOUNTING ACCESSORIES *ORDERED SEPARATELY

When ordering after initial fixture purchase, replace XXX with color code BRN, WH, BLK or CUS. (If CUS, provide factory with RAL, extended lead time.)

WALL BRACKETS⁷

LL-SL1-A1-XXX Vertical or Horizontal Mount for Flat Surfaces

LL-SL1-A2-XXX Horizontal Mount for Round Poles

LL-SL1-A3-XXX Horizontal Wall Mount

LL-SL1-A4-XXX Vertical Wall Mount

LL-SL1-A10-XXX Single Fixture Multi-Mount Bracket

ADAPTER⁷

LL-SL1-A12-XXX Round to Square Pole Adapter

LL-SL1-A5-XXX Square to Vertical Slip Fitter Adapter for 4" Square Pole

LL-SL1-A6-XXX Square to Vertical Slip Fitter Adapter for 5" Square Pole

LL-SL1-A18-XXX Square to Vertical Slip Fitter Adapter for 6" Square Pole

LL-SL1-A7-XXX Round Pole to Slip Fitter Adapter for 4" Round Pole

LL-SL1-A14-XXX Round Pole to Slip Fitter Adapter for 3" Round Pole

LL-SL1-A17-XXX Slip Fitter Adapter for 4"-5" Square Poles

TENONS & CROSS ARMS⁸

LL-SL1-A8-XXX Two Fixture Bullhorn

LL-SL1-A9-XXX Three Fixture Y Tenon

LL-SL1-A11-XXX Three Fixture Straight Tenon

LL-SL1-A13-XXX Four Fixture 90° Cross Arm

LL-SL1-A15-XXX Three Fixture T Tenon

LL-SL1-A16-XXX Two Fixture L Tenon

FEATURES & SPECIFICATIONS

CONSTRUCTION

- **Extruded Aluminum Body:** Improves heat dissipation.
- **Heavy-Duty Powder Coating:** Bronze, white and black standard. Other color options available¹¹.
- **Modern Form Factor**
- **Assembled in the USA**

ELECTRICAL

- **Power Input:** 120-277V or 200-480V, depending on model.
- **Power Factor:** >0.9 (0.99 typical).
- **Total Harmonic Distortion:** <10% typical.
- **Surge Protection:** Standard is 3kV for drivers. Additional surge protection is available.

OPERATION

- **Environment:** Wet locations for exterior applications. IP65 rated.
- **Ambient Range Operation:** -40°C up to 55°C (-40°F up to 130°F).

KELVIN

- **CCT:** 2200K, 3000K, 3500K, 4000K and 5000K standard.
- **CRI:** >70.
- **Lenses:** UV stable Polycarbonate Clear.

MOUNTING

- **Mounting:** U.S. Patented Rapid Mount Bracket. Other options are Slip Fitter (Knuckle Adapter), Straight Arm and Trunnion (Yoke) Bracket.



CONTROLS²

- **Dimming:** 0-10V standard. Dim to OFF.
- **Sensors:** Compatible with WattStopper and McWong sensors, and EnOcean switches.
- **Networked Control Options:** Compatible with Avi-On¹⁰ networked controls and UltraLink SIG Bluetooth® with Mesh Networked Controls³.

WARRANTY

- **Standard:** 10-year product warranty, including driver.

LISTINGS & CERTIFICATIONS

- UL 1598.
- IP65.
- FCC CFR 47, Part 15: Subpart B Class B.
- ANSI C63.4: 2014.
- RoHS compliant.
- cUL.
- BAA/TAA Compliant.
- Design Lights™ Consortium Premium¹.



LIGHT DISTRIBUTION

50W T5 3500K

Polar Graph

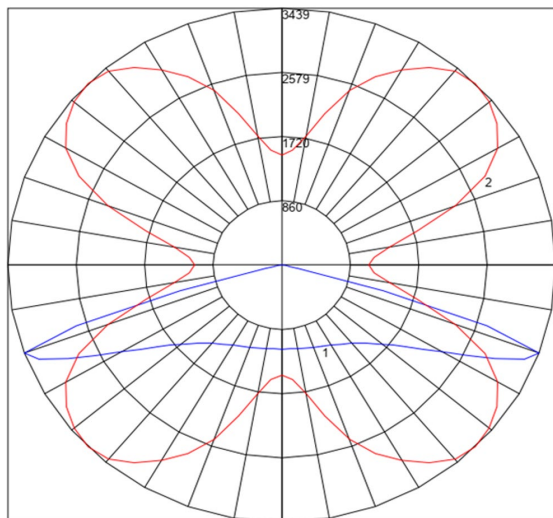

Maximum Candela: 3439

Located at horizontal angle: 45, Vertical angle : 70

#1: Vertical plane through horizontal angles (45-225)(through max Cd.)

#2: Horizontal cone through vertical angle (70)(through max Cd.)

50W T2 3500K

Polar Graph

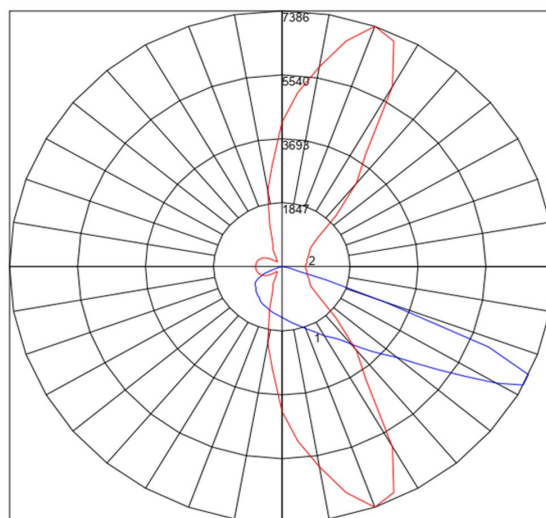

Maximum Candela: 7386

Located at horizontal angle: 70, Vertical angle : 62.5

#1: Vertical plane through horizontal angles (70-250)(through max Cd.)

#2: Horizontal cone through vertical angle (62.5)(through max Cd.)

50W T3 3500K

Polar Graph

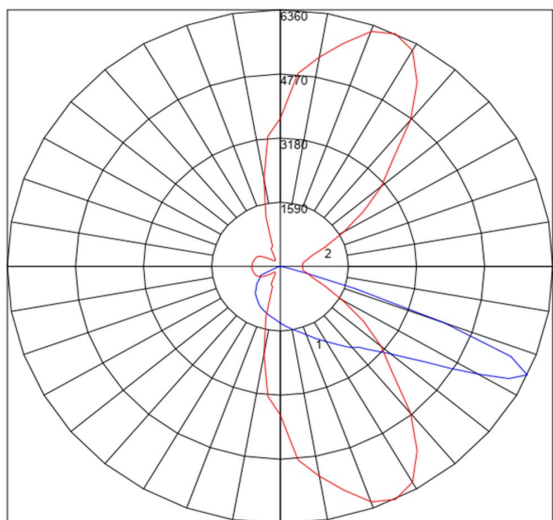

Maximum Candela: 6360

Located at horizontal angle: 65, Vertical angle : 65

#1: Vertical plane through horizontal angles (65-245)(through max Cd.)

#2: Horizontal cone through vertical angle (65)(through max Cd.)

50W T4 3500K

Polar Graph

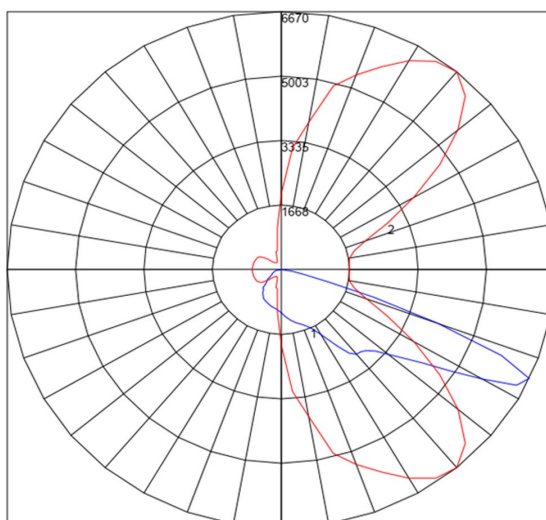

Maximum Candela: 6670

Located at horizontal angle: 50, Vertical angle : 65

#1: Vertical plane through horizontal angles (50-230)(through max Cd.)

#2: Horizontal cone through vertical angle (65)(through max Cd.)

LIGHT DISTRIBUTION

50W F35 3500K

Polar Graph

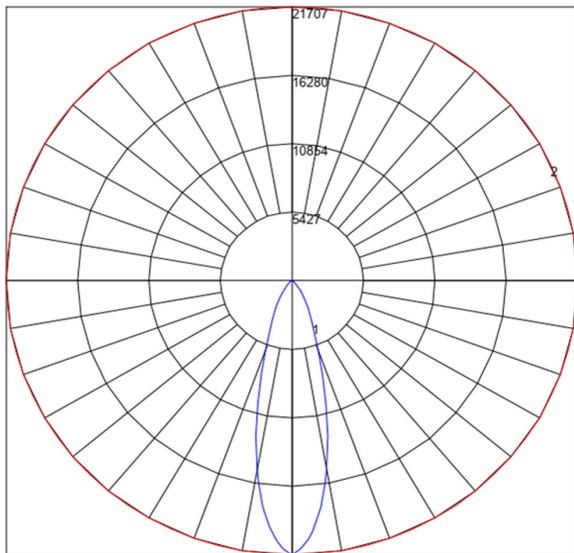

Maximum Candela: 21707

Located at horizontal angle: 90, Vertical angle : 0

#1: Vertical plane through horizontal angles (90-270)(through max Cd.)

#2: Horizontal cone through vertical angle (0)(through max Cd.)

50W F60 3500K

Polar Graph

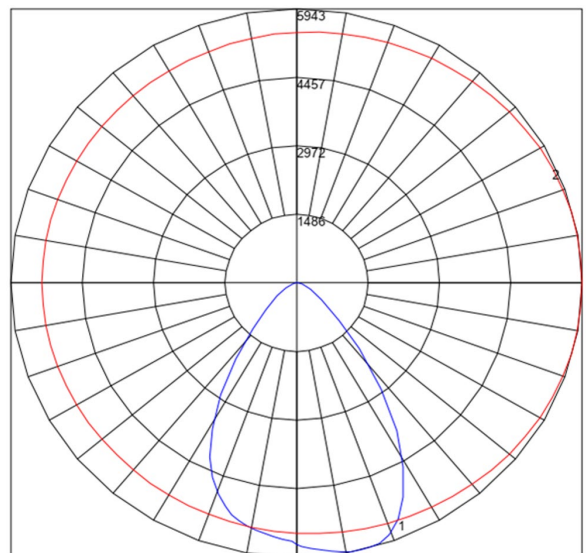

Maximum Candela: 5943

Located at horizontal angle: 0, Vertical angle : 13

#1: Vertical plane through horizontal angles (0-180)(through max Cd.)

#2: Horizontal cone through vertical angle (13)(through max Cd.)

50W FR 3500K

Polar Graph

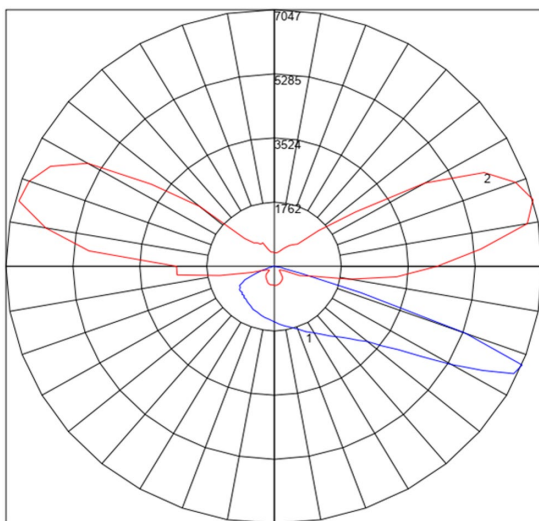

Maximum Candela: 7047

Located at horizontal angle: 15, Vertical angle : 67.5

#1: Vertical plane through horizontal angles (15-195)(through max Cd.)

#2: Horizontal cone through vertical angle (67.5)(through max Cd.)

50W FL 3500K

Polar Graph

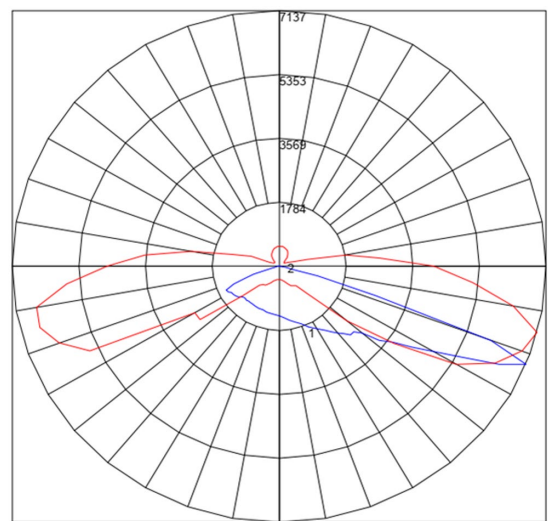

Maximum Candela: 7137

Located at horizontal angle: 345, Vertical angle : 67.5

#1: Vertical plane through horizontal angles (345-165)(through max Cd.)

#2: Horizontal cone through vertical angle (67.5)(through max Cd.)

DIMENSIONS & DRAWINGS

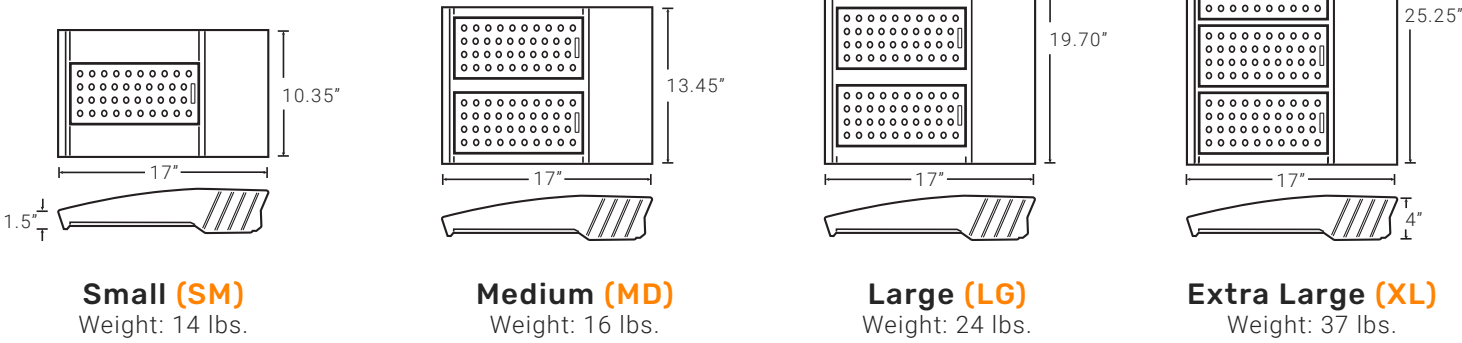

DIMENSIONS				
Size	Length (in)	Width (in)	Height (in)	Weight (lb)
SM	17	10.35	4	14
MD	17	13.45	4	16
LG	17	19.70	4	24
XL	17	25.25	4	37

OCCUPANCY SENSORS

WATTSTOPPER

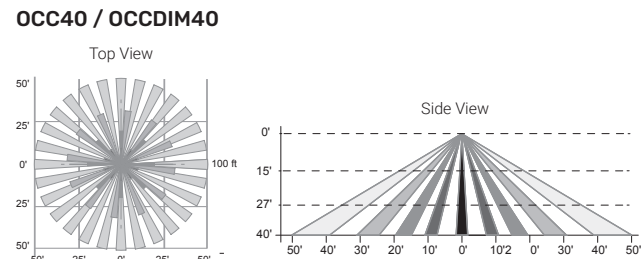

MCWONG (FOR USE WITH ULTRALINK)

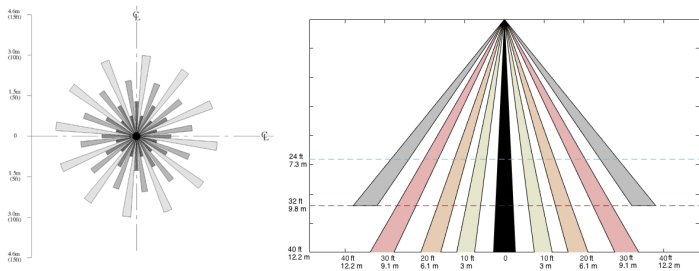

AVION

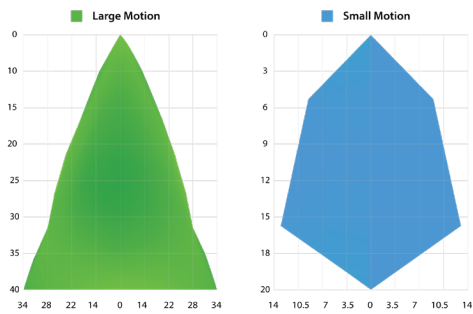

EPA RATINGS

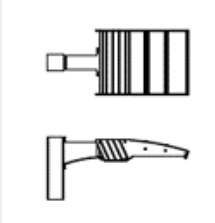
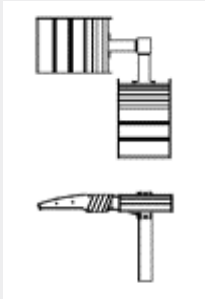
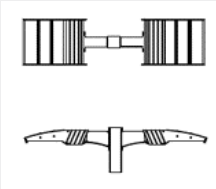
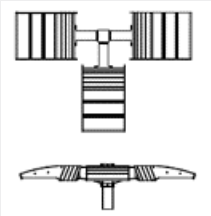
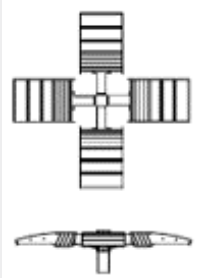
BEAM ANGLE	NO.	ITEM										
0°	1	SM	0.58	0.81	1.15	1.29	1.29					
	2	MD	0.58	0.85	1.15	1.30	1.30					
	3	LG	0.58	0.98	1.15	1.32	1.32					
	4	XL	0.58	1.07	1.15	1.33	1.33					
15°	1	SM	0.59	1.11	1.17	1.69	1.69					
	2	MD	0.67	1.25	1.33	2.00	2.00					
	3	LG	0.97	1.56	1.94	2.90	2.90					
	4	XL	1.24	1.83	2.48	3.73	3.73					
30°	1	SM	0.85	1.44	1.70	2.55	2.55					
	2	MD	1.10	1.69	2.21	3.31	3.31					
	3	LG	1.60	2.19	3.20	4.80	4.80					
	4	XL	2.04	2.63	4.08	6.12	6.12					
45°	1	SM	1.15	1.74	2.29	3.44	3.44					
	2	MD	1.48	2.07	2.97	4.45	4.45					
	3	LG	2.14	2.73	4.29	6.43	6.43					
	4	XL	2.74	3.33	5.47	8.21	8.21					
60°	1	SM	1.37	1.96	2.74	4.11	4.11					
	2	MD	1.77	2.36	3.54	5.32	5.32					
	3	LG	2.56	3.15	5.11	7.67	7.67					
	4	XL	3.26	3.85	6.52	9.78	9.78					

FOOTNOTES

1. Check QPL for up-to-date listings.
2. Synapse, Daintree and Enlighted are available with extended lead time. Electrical changes and additional components required to make fixture compatible.
3. Requires EnOcean switch, McWong sensor or a gateway for complete functionality.
4. Provide RAL or contact factory. Extended lead time.
5. Must specify left or right side. Contact factory.
6. Consult factory when installing 2 or more fixtures on a single pole with less than 180° separation between fixtures.
7. When ordering accessory with fixture, the fixture color will be applied. Custom color is a cost adder with extended lead time.
8. When ordering accessory with fixture, the fixture color will be applied. Custom color will have extended lead time.
9. Not DLC listed.
10. Contact your regional sales director.
11. Custom colors are a cost adder with extended lead time.

Linmore LED Labs, Inc.

2360 S. Orange Ave, Bldg. 1, Fresno, CA 93725

559.485.6010 | info@linmoreled.com | LinmoreLED.com



All specifications are subject to change without notice. Please visit linmoreled.com for latest information. All values are typical or design values and series averages. Actual performance may differ as a result of end-user environments and applications. Consult Linmore LED with specific inquiries. Copyright © 2021, Linmore LED Labs, Inc. All rights reserved. No part of this document may be reproduced in any form without the prior written permission of Linmore LED.

Updated: 2021.05.21

FIXTURE BRACKETS



Part Number	LL-SL1-RMB
Application	Rapid Mount Bracket (U.S. Patent No. 10,845,039)
Purpose	Universal bracket for round or square pole.
Fixture Mounting	For use with all Linmore SL1 fixtures. Rapid installation of round or square pole without any new drilling of holes required.
Weight	7 lbs.

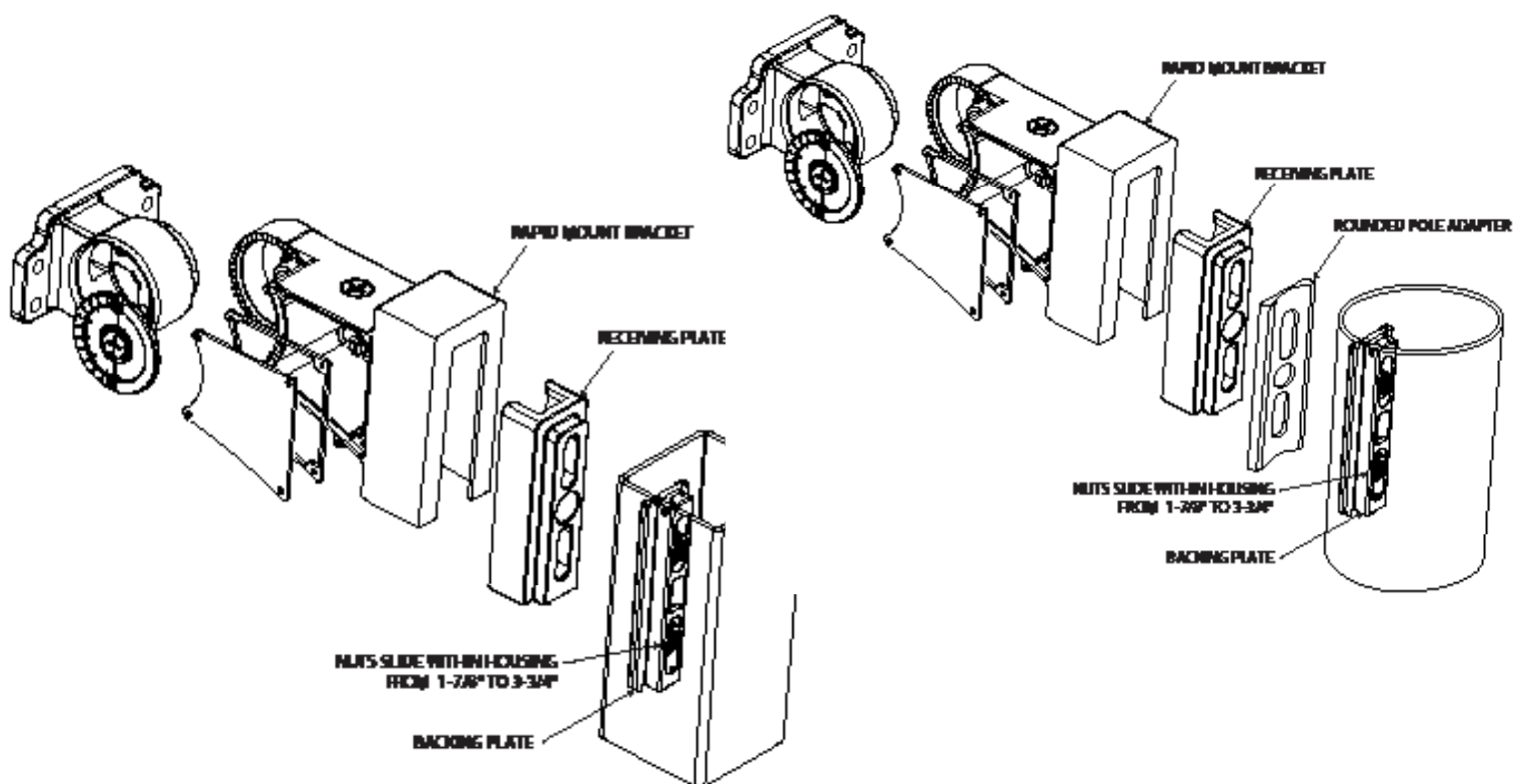
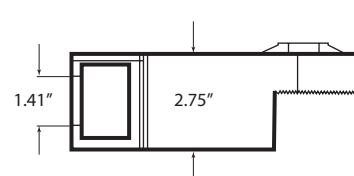
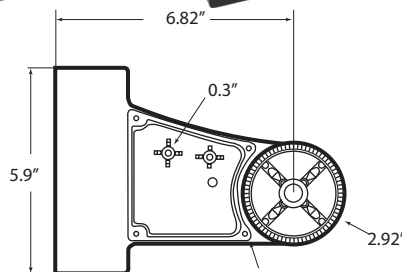
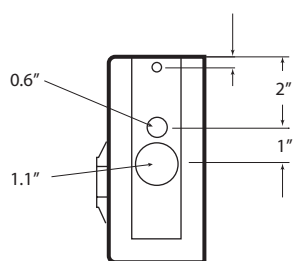
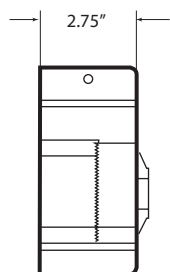



Part Number	LL-SL1-SA
Application	Straight Arm Mount
Purpose	Used for fixed horizontal applications.
Fixture Mounting	Accommodates a single fixture horizontally mounted.
Weight	3 lbs.
Options	Bracket bolts to a square pole or wall for horizontal applications.

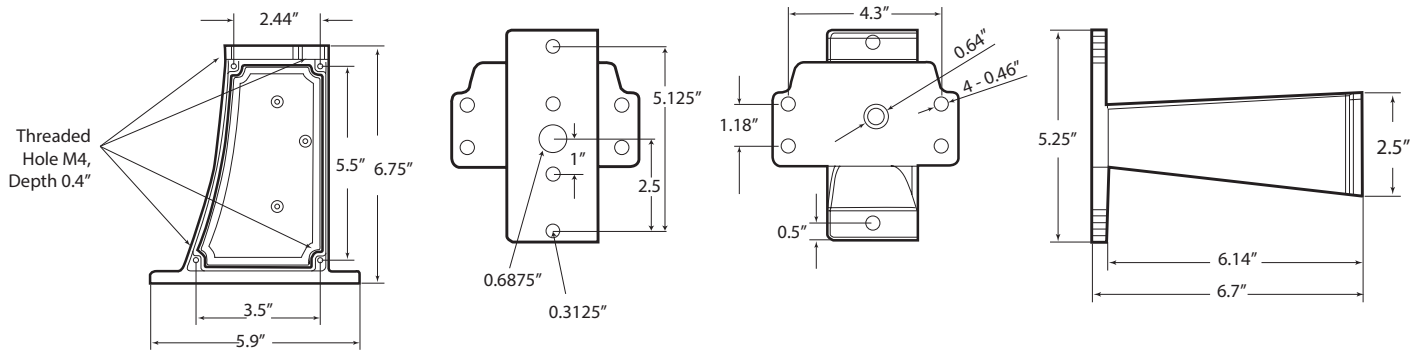

Part Number	LL-SL1-A12
Application	Round to Square Pole Adapter
Purpose	To mount a Straight Arm Mount to a round pole. For use with Straight Arm Mount.
Fixture Mounting	N/A
Weight	1 lb.

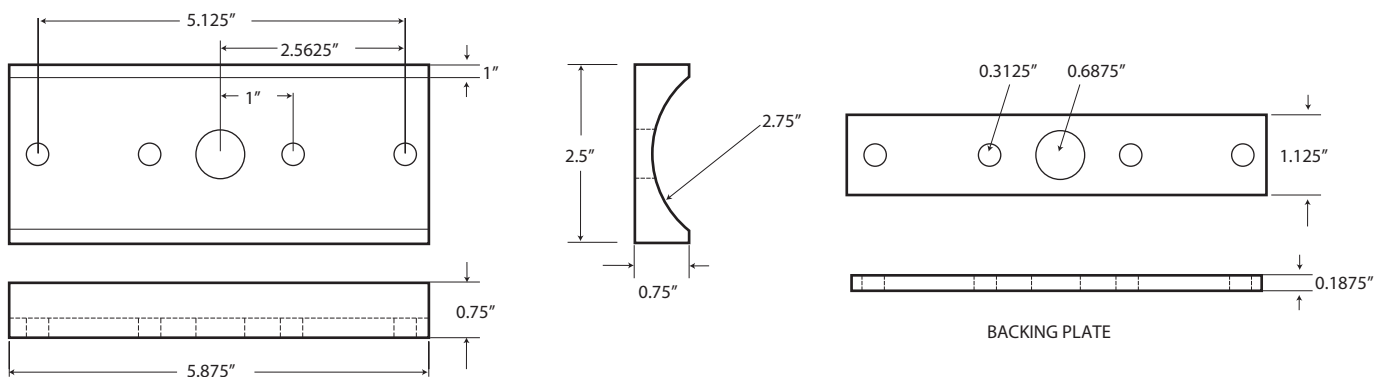

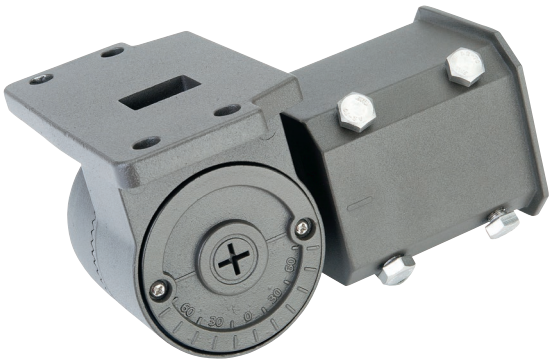

Part Number	LL-SL1-SF
Application	Slip Fitter
Purpose	Bracket used for vertical or horizontal, adjustable angle applications.
Fixture Mounting	Accommodates a single fixture mounting vertically or horizontally to round pipe with no greater than 2 1/2" O.D.
Weight	3 lbs.



Part Number	LL-SL1-TM
Application	Trunnion (Yoke) Bracket
Purpose	To mount SL1 fixtures to multiple surfaces allowing the fixture to be installed in unique applications.
Fixture Mounting	Accommodates a single fixture mounting to variety of surfaces at any angle.
Weight	3 lbs.

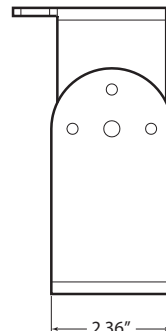
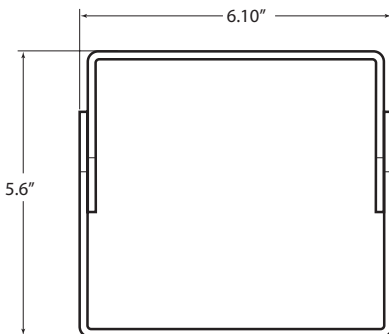
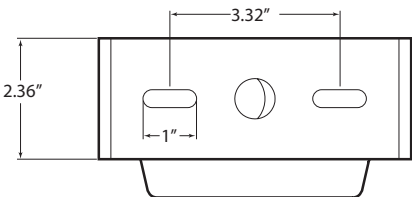

TENONS

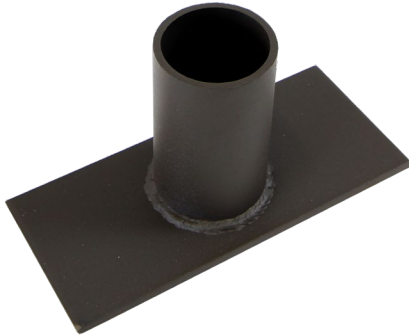

Part Number	LL-SL1-A1
Application	Vertical or Horizontal Tenon
Purpose	For use with 4" and larger square poles or flat surfaces.
Fixture Mounting	Accommodate fixtures mounting vertically or horizontally with 2-3/8" slip fitter.
Weight	4 lbs.

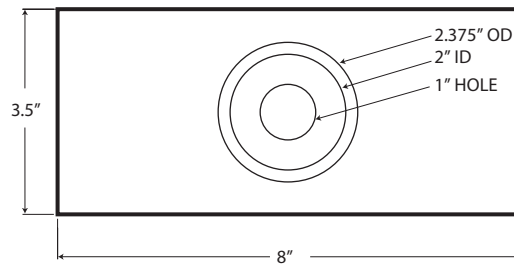
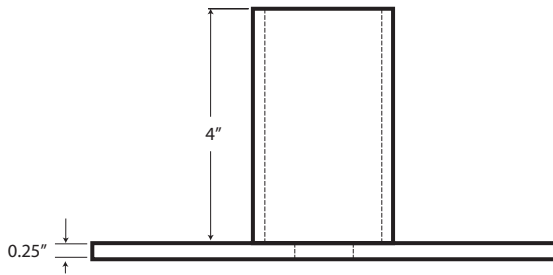

Part Number	LL-SL1-A2
Application	Round Pole Horizontal Tenon
Purpose	For use with round poles.
Fixture Mounting	Accommodates fixtures mounting horizontally with 2-3/8" to 3" slip fitter.
Weight	4 lbs.

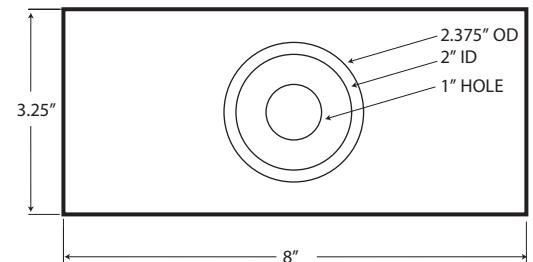
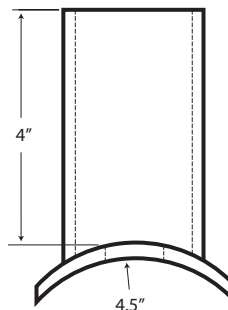
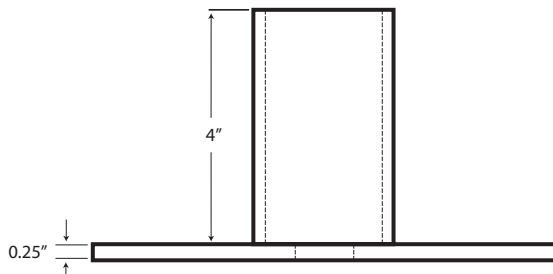



Part Number	LL-SL1-A3
Application	Vertical or Horizontal Mount Tenon
Purpose	For use with flat surfaces including walls and flooring providing a round pipe for mounting SL1 Fixtures with a Slip Fitter Bracket or adding Cross Arms.
Fixture Mounting	Accommodates fixtures mounting horizontally with 2-3/8" to 3" slip fitter.
Weight	6.5 lbs.

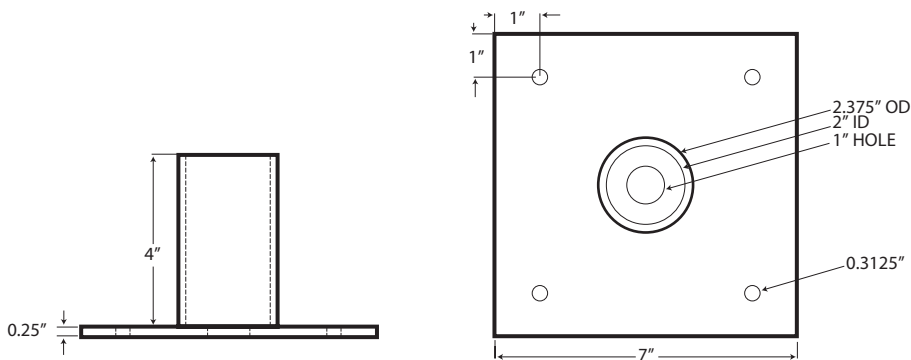

Part Number	LL-SL1-A4
Application	Vertical Wall Mount Tenon
Purpose	For use with walls providing a vertical round pipe for mounting SL1 Fixtures with a Slip Fitter Bracket or adding Cross Arms.
Fixture Mounting	Accommodates fixtures mounting vertically with 2-3/8" to 3" slip fitter.
Weight	8 lbs.

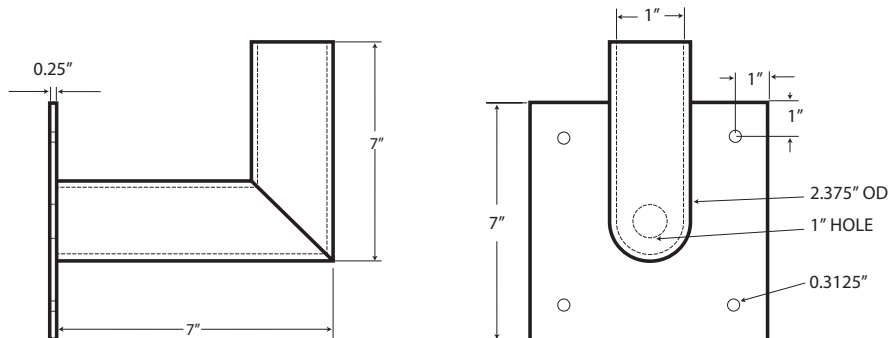



Part Number	LL-SL1-A10
Application	Single-Fixture Multi-Mount Tenon
Purpose	To add a round pipe for mounting SL1 Fixtures with a Slip Fitter Bracket to a variety of vertical and horizontal surfaces creating unique options for fixture placement.
Fixture Mounting	Accommodates single fixtures in any mounting position.
Weight	1 lb.

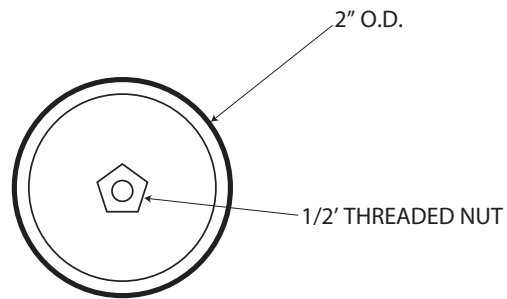
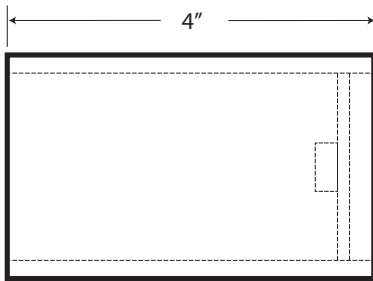

ADAPTERS



Part Number	LL-SL1-A5
Application	Square Pole to Vertical Slip Fitter Adapter
Purpose	Converts mounting 4" square pole to 2-3/8" O.D. vertical mount.
Fixture Mounting	Accommodates fixtures mounting vertically with 2-3/8" to 3" slip fitter.
Weight	7 lbs.

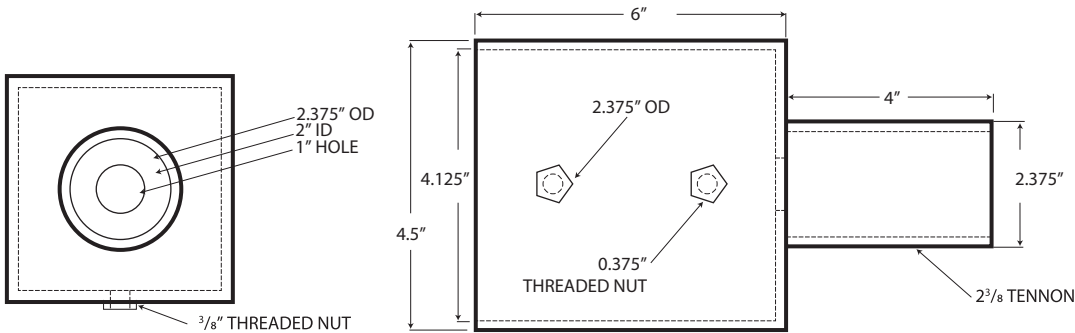

Part Number	LL-SL1-A6
Application	Square Pole to Vertical Slip Fitter Adapter
Purpose	Converts mounting 5" square pole to 2-3/8" O.D. vertical mount.
Fixture Mounting	Accommodates fixtures mounting vertically with 2-3/8" to 3" slip fitter.
Weight	9 lbs.

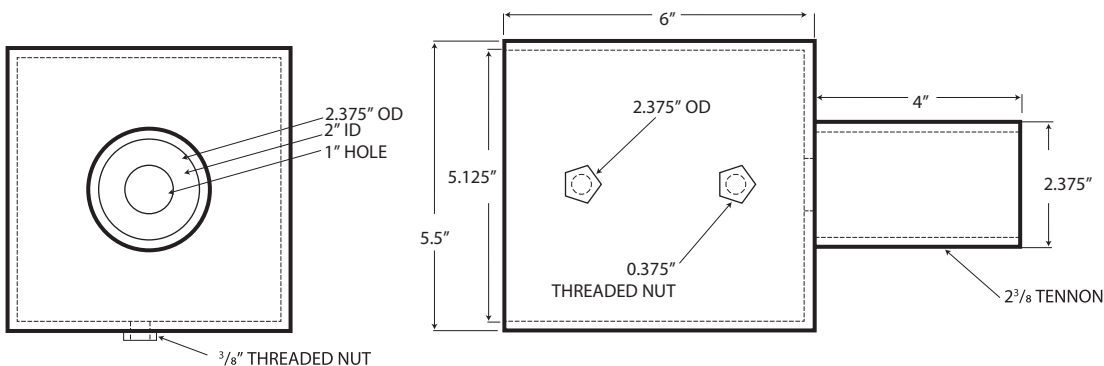



Part Number	LL-SL1-A18
Application	Square Pole to Vertical Slip Fitter Adapter
Purpose	Converts mounting 6" square pole to 2-3/8" O.D. vertical mount.
Fixture Mounting	Accommodates fixtures mounting vertically with 2-3/8" to 3" slip fitter.
Weight	9 lbs.

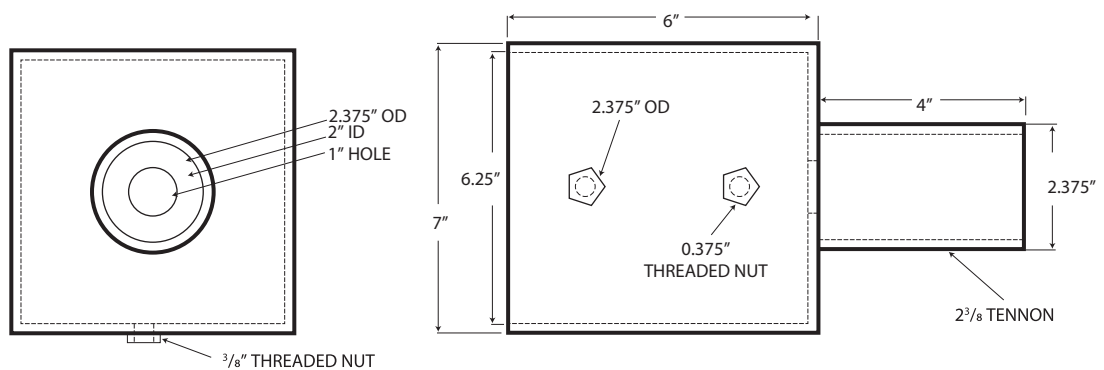

Part Number	LL-SL1-A7
Application	Round Pole to Vertical Slip Fitter Adapter
Purpose	Converts mounting 4" round pole to 2-3/8" O.D. vertical mount.
Fixture Mounting	Accommodates fixtures mounting vertically with 2-3/8" to 3" slip fitter.
Weight	8 lbs.

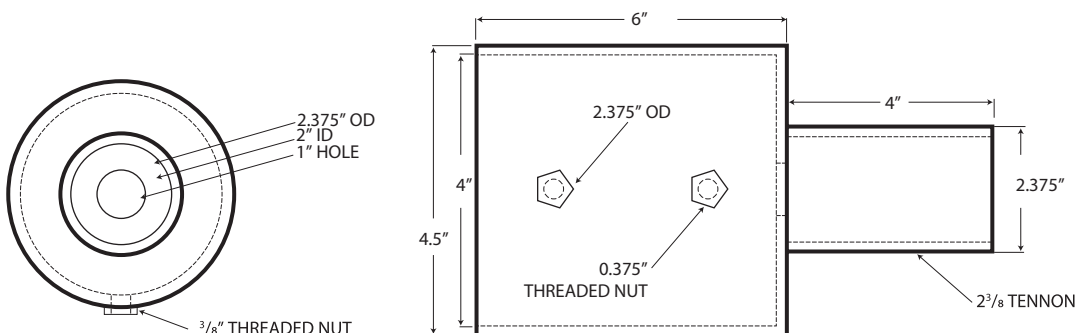

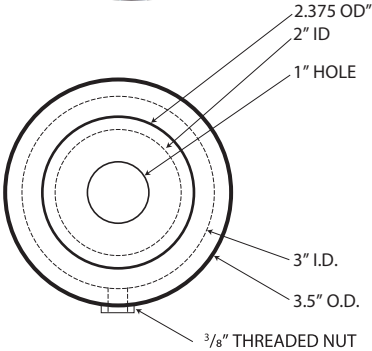

Part Number	LL-SL1-A14
Application	Round Pole to Vertical Slip Fitter Adapter
Purpose	Bracket reduces from 3" pole to 2-3/8" O.D.
Fixture Mounting	Accommodates a single fixture mounting vertically.
Weight	6 lbs.

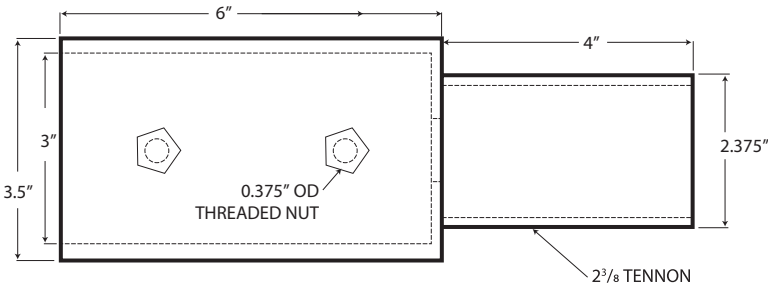

Part Number	LL-SL1-A17
Application	Clamp-On Mid-Pole Vertical Slip Fitter Adapter
Purpose	For use with 4"-5" square poles to provide a round vertical pipe for mounting SL1 Fixtures with a Slip Fitter Bracket at a position on the pole that is not the top.
Fixture Mounting	Accommodates fixtures mounting vertically with 2-3/8" to 3" slip fitter.
Weight	17 lbs.

CROSS ARMS

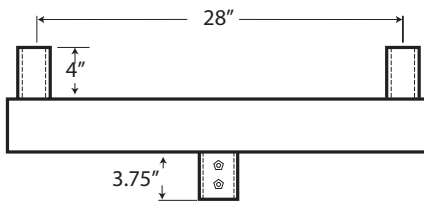

4x4x0.125 SQUARE TUBING



Part Number	LL-SL1-A8
Application	Two Fixture Straight Cross Arm
Purpose	Adapts from single 2-3/8" O.D. to two vertical mounting locations, 2-3/8" at 28" on center apart.
Fixture Mounting	Accommodates two fixtures mounting vertically with 2-3/8" to 3" slip fitter.
Weight	23 lbs.

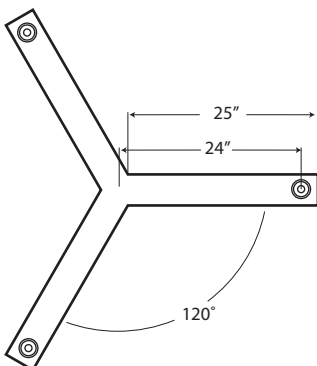

4x4x0.125" SQUARE TUBING

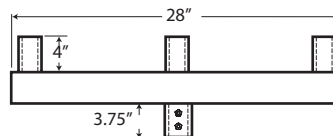

Part Number	LL-SL1-A9
Application	Three Fixture 120° Cross Arm
Purpose	Adapts from single 2-3/8" O.D. to three vertical mounting locations, 2-3/8" at 28" on center apart.
Fixture Mounting	Accommodates three fixtures mounting vertically with 2-3/8" to 3" slip fitter.
Weight	44 lbs.



Part Number	LL-SL1-A11
Application	Three Fixture Straight Cross Arm
Purpose	Adapts from single 2-3/8" O.D. to three vertical mounting locations, 2-3/8" at 28" on center apart.
Fixture Mounting	Accommodates three fixtures mounting vertically with 2-3/8" to 3" slip fitter.
Weight	40 lbs.

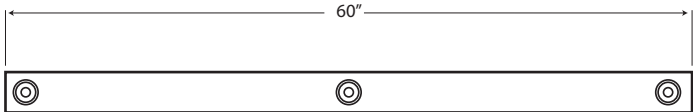
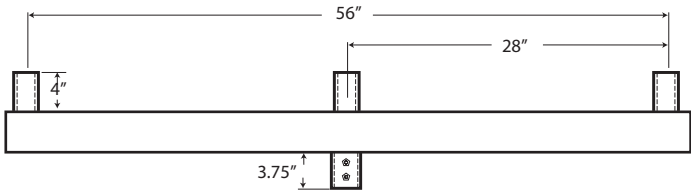

4x4x0.125" SQUARE TUBING



Part Number	LL-SL1-A13
Application	Four Fixture 90° Cross Arm
Purpose	Adapts from single 2-3/8" O.D. to four vertical mounting locations, 2-3/8" at 28" on center apart.
Fixture Mounting	Accommodates four fixtures mounting vertically with 2-3/8" to 3" slip fitter.
Weight	

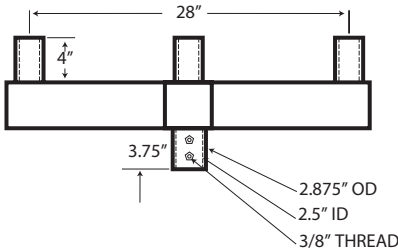
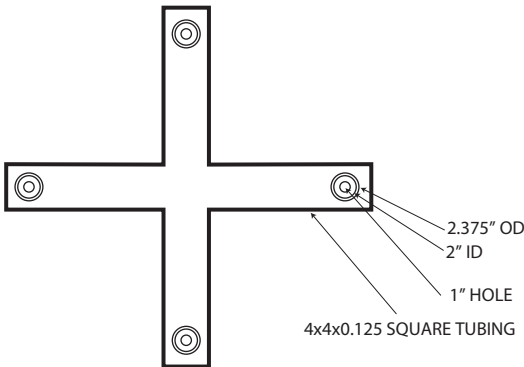



Part Number	LL-SL1-A15
Application	Three Fixture 90° Cross Arm
Purpose	Adapts from single 2-3/8" O.D. to three vertical mounting locations at 28" on center apart.
Fixture Mounting	Accommodates three fixtures mounting vertically with 2-3/8 to 3" slip fitter.
Weight	

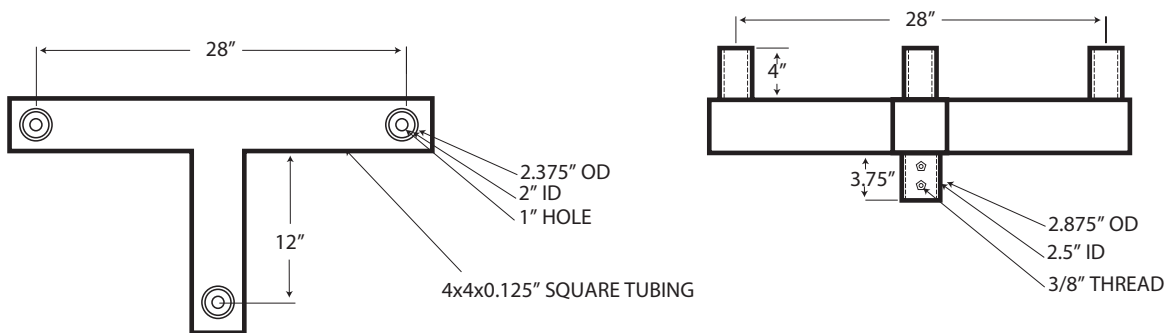

Part Number	LL-SL1-A16
Application	Two Fixture 90° Cross Arm
Purpose	Adapts from single 2-3/8" O.D. to two vertical mounting locations at 22.65" on center apart.
Fixture Mounting	Accommodates two fixtures mounting vertically with 2-3/8 to 3" slip fitter.
Weight	

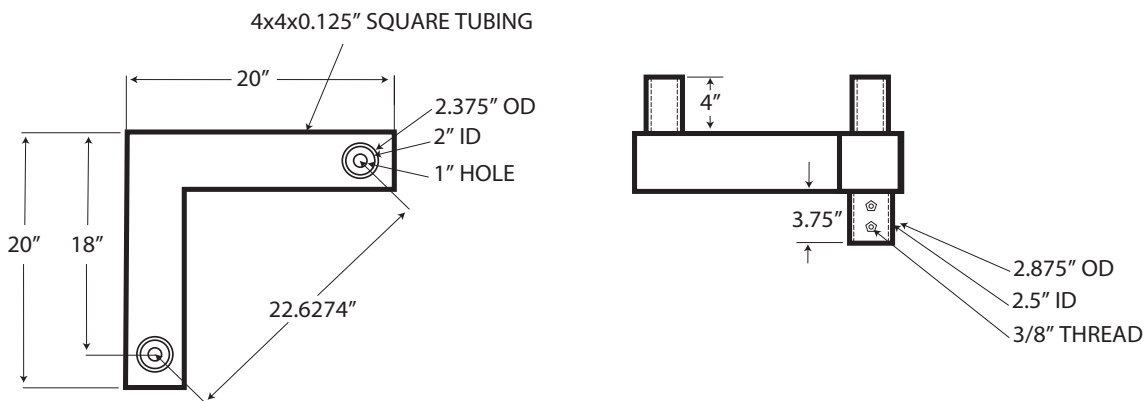

ACCESSORIES



Part Number	GSS
Application	Glare Shield - Side
Purpose	Cut-off shield used on outdoor fixtures to direct light.
Fixture Mounting	Two panels mounted to either side of the Site Lighter fixture to direct light
Weight	1 lbs.

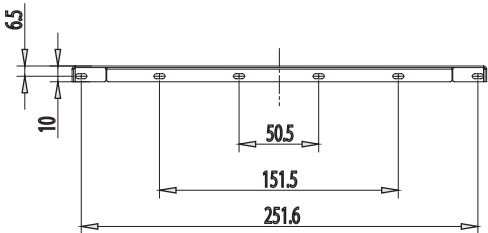
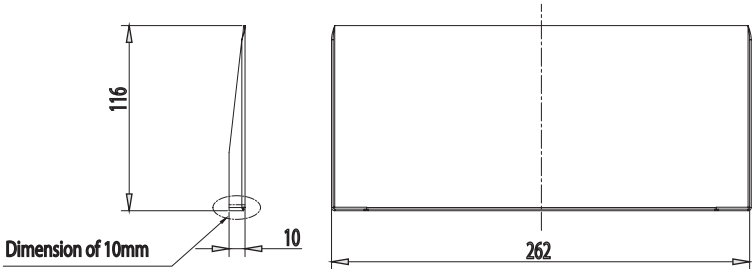
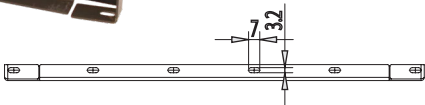

Part Number	GSB (SL1-SM-G2)
Application	Glare Shield - Back
Purpose	Cut-off shield used on outdoor fixtures to direct light.
Fixture Mounting	Mounted to lower part of the Site Lighter fixture
Weight	1 lbs.

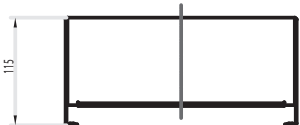
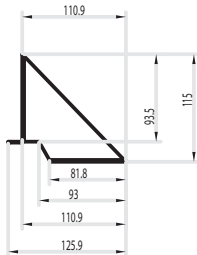
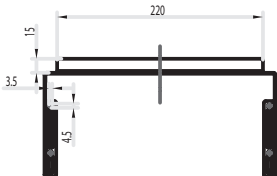
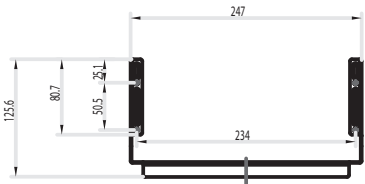

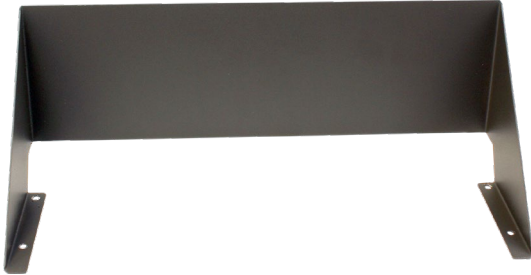

Part Number	GSB (SL1-MD-G2)
Application	Glare Shield - Back
Purpose	Cut-off shield used on outdoor fixtures to direct light.
Fixture Mounting	Mounted to lower part of the Site Lighter fixture
Weight	1 lbs.

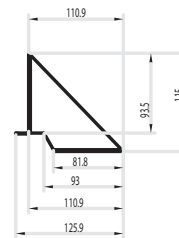
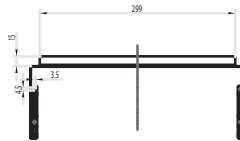
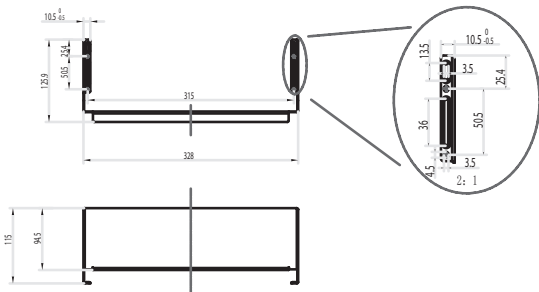

Part Number	GSB (SL1-LG-G2)
Application	Glare Shield - Back
Purpose	Cut-off shield used on outdoor fixtures to direct light.
Fixture Mounting	Mounted to lower part of the Site Lighter fixture
Weight	1 lbs.

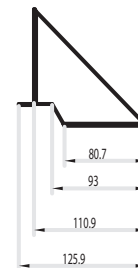
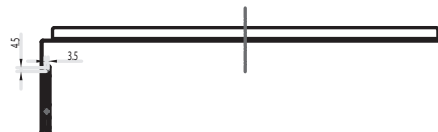
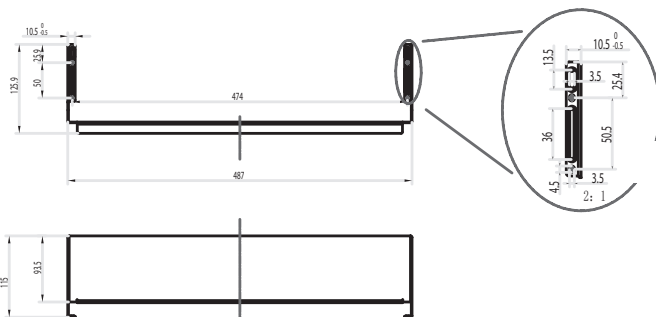



Part Number	GSB (SL1-XL-G2)
Application	Glare Shield - Back
Purpose	Cut-off shield used on outdoor fixtures to direct light.
Fixture Mounting	Mounted to lower part of the Site Lighter fixture
Weight	1 lbs.

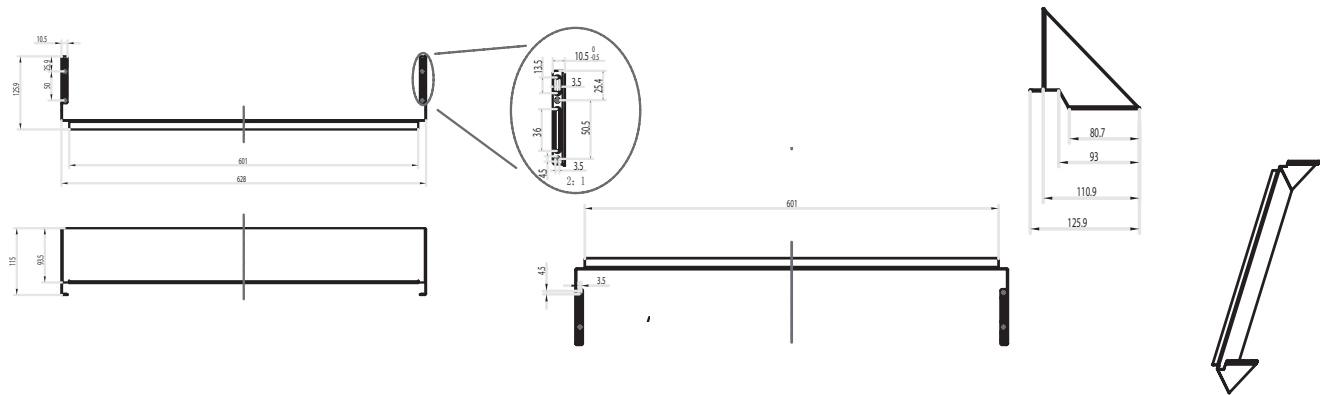

Part Number	LL-SL1-A30
Application	Spacer
Purpose	Pole Spacer
Fixture Mounting	To accommodate 4 large Site Lighters on a quad pole mount.
Weight	2 lbs.

